

# LINX

VEHICLE ACCESSORY INTERFACE



## OPERATION GUIDE

LX100 Vehicle Accessory Interface Kit | 24.08.20





# WHAT IS LINX?

---

# WHAT IS LINX?

**LINX is a sleek touchscreen interface that enables total control of both new and existing 4X4 Accessories. Gone are the days where the only option for installing aftermarket switches meant drilling multiple holes into the dashboard.**

## INTRODUCING TOTAL CONTROL

LINX is a unique modern controller that declutters the dashboard and centralises the command of vehicle accessories by replacing classic switches, gauges and monitors with one sleek and smart driver interface. Built on an expandable platform, LINX will continue to evolve your on and off road driving experience both now and into the future.

The mobile touchscreen display integrates seamlessly into the vehicle cabin and mounts to a magnetic gimbal that's installed within easy reach of the driver. This connects to the LINX Controller which is the brains behind the system, and is conveniently installed out-of-sight either underneath the dash or the seat.



### STAY IN THE LOOP

For the latest details, updates and list of accessories, head over to:

[www.linx.arb.com.au](http://www.linx.arb.com.au)

# TABLE OF CONTENTS

Get to know the basic in's and out's of your brand new LINX - the next generation of 4x4 Accessories.

## KIT CONTENTS

|     |                                    |     |
|-----|------------------------------------|-----|
| 01. | <a href="#">WHAT'S IN THE BOX?</a> | p.7 |
|-----|------------------------------------|-----|

## OVERVIEW

|     |  |      |
|-----|--|------|
| 02. | <a href="#">COMPATIBLE ARB ACCESSORIES</a> | p.9  |
| 03. | <a href="#">OPTIONAL ACCESSORIES</a>       | p.10 |

## INITIAL SETUP

|     |   |      |
|-----|---|------|
| 04. | <a href="#">SETTING UP YOUR LINX</a>                          | p.13 |
| 05. | <a href="#">GETTING STARTED</a>                               | p.14 |
|     | <a href="#">SWITCHING ON/OFF</a>                              | p.15 |
|     | <a href="#">UPDATING LINX SOFTWARE</a>                        | p.16 |
|     | <a href="#">BLUETOOTH PAIRING THE DISPLAY WITH CONTROLLER</a> | p.18 |

## OPERATING LINX

|     |  |      |
|-----|--|------|
| 06. | <a href="#">LINX DISPLAY</a>                       | p.21 |
| 07. | <a href="#">HOME SCREEN</a>                        | p.22 |
| 08. | <a href="#">SETTINGS MENUS</a>                     | p.24 |
|     | <a href="#">QUICK SETTINGS MENU</a>                | p.24 |
|     | <a href="#">MAIN SETTINGS MENU</a>                 | p.24 |
| 09. | <a href="#">LINX USER INTERFACE</a>                | p.25 |
|     | <a href="#">LINX DISPLAY SCREENS</a>               | p.26 |
| 10. | <a href="#">LINX MAIN ICON SCREEN</a>              | p.27 |
|     | <a href="#">ACCESSING EACH MODULE</a>              | p.28 |
|     | <a href="#">RETURNING TO LINX MAIN ICON SCREEN</a> | p.28 |
|     | <a href="#">LINX SETTINGS SCREEN</a>               | p.29 |
| 11. | <a href="#">UPDATING LINX</a>                      | p.30 |

## MODULES OVERVIEW

|     |  |      |
|-----|--|------|
| 12. | <a href="#">FRONT AND REAR TRACTION MODULES</a>                | p.32 |
|     | <a href="#">CONFIGURING TRACTION MODULES: AIR LOCKER SETUP</a> | p.33 |
| 13. | <a href="#">COMPRESSOR MODULE</a>                              | p.35 |
|     | <a href="#">SWITCHING ON COMPRESSOR</a>                        | p.35 |
|     | <a href="#">CONFIGURING COMPRESSOR MODULE</a>                  | p.36 |
|     | <a href="#">CONFIGURING PRESSURE CONTROL</a>                   | p.36 |
|     | <a href="#">PRESSURE CONTROL MODE LIST</a>                     | p.38 |

|                               |  |                      |
|-------------------------------|--|----------------------|
| 14.                           | <a href="#">SWITCHBOARD MODULE</a>                             | <a href="#">p.40</a> |
|                               | <a href="#">CONFIGURING SWITCHBOARD MODULE</a>                 | <a href="#">p.40</a> |
|                               | <a href="#">SWITCHING ON/OFF AN ACCESSORY</a>                  | <a href="#">p.46</a> |
| 15.                           | <a href="#">BATTERY MODULE</a>                                 | <a href="#">p.48</a> |
|                               | <a href="#">CONFIGURING BATTERY MODULE</a>                     | <a href="#">p.48</a> |
|                               | <a href="#">BATTERY MONITORING IN FULLSCREEN</a>               | <a href="#">p.52</a> |
| 16.                           | <a href="#">SPEEDOMETER MODULE</a>                             | <a href="#">p.53</a> |
|                               | <a href="#">CONFIGURING SPEEDOMETER</a>                        | <a href="#">p.53</a> |
|                               | <a href="#">SETTING SPEED LIMIT WARNING</a>                    | <a href="#">p.54</a> |
| 17.                           | <a href="#">AIR SUSPENSION MODULE</a>                          | <a href="#">p.55</a> |
|                               | <a href="#">CONFIGURING AIR SUSPENSION</a>                     | <a href="#">p.55</a> |
|                               | <a href="#">RENAMING MODES</a>                                 | <a href="#">p.57</a> |
|                               | <a href="#">ADJUSTING AIR PRESSURE</a>                         | <a href="#">p.58</a> |
|                               | <a href="#">AUTO ADJUST WITH VEHICLE START</a>                 | <a href="#">p.58</a> |
| 18.                           | <a href="#">INCLINOMETER MODULE</a>                            | <a href="#">p.59</a> |
|                               | <a href="#">CONFIGURING THE INCLINOMETER</a>                   | <a href="#">p.60</a> |
| 19.                           | <a href="#">CLOCK MODULE</a>                                   | <a href="#">p.61</a> |
| 20.                           | <a href="#">FRIDGE MODULE</a>                                  | <a href="#">p.63</a> |
|                               | <a href="#">CONNECTING TO THE FRIDGE</a>                       | <a href="#">p.63</a> |
|                               | <a href="#">CONFIGURING FRIDGES WITH TWO WAY COMMUNICATION</a> | <a href="#">p.65</a> |
|                               | <a href="#">FRIDGE MONITORING IN FULLSCREEN</a>                | <a href="#">p.67</a> |
| 21.                           | <a href="#">TPMS MODULE</a>                                    | <a href="#">p.68</a> |
|                               | <a href="#">CONNECTING TO THE LINX TPMS COMMS BOX</a>          | <a href="#">p.68</a> |
|                               | <a href="#">SENSOR POSITION PROGRAMMING</a>                    | <a href="#">p.69</a> |
|                               | <a href="#">CONFIGURING TPMS ALERTS</a>                        | <a href="#">p.71</a> |
|                               | <a href="#">TPMS DISPLAY</a>                                   | <a href="#">p.72</a> |
|                               | <a href="#">AUTOMATIC TRAILER DETECTION</a>                    | <a href="#">p.74</a> |
| <b>COMPLIANCE INFORMATION</b> |  |                      |
| 22.                           | <a href="#">COMPLIANCE INFORMATION</a>                         | <a href="#">p.76</a> |
|                               | <a href="#">EUROPE - EU DECLARATION OF CONFORMITY</a>          | <a href="#">p.76</a> |
|                               | <a href="#">USA - FCC STATEMENT</a>                            | <a href="#">p.77</a> |
|                               | <a href="#">ENVIRONMENTAL PROTECTION</a>                       | <a href="#">p.77</a> |





# KIT CONTENTS

Each and every component to get your new LINX up and running.

[BACK TO TABLE OF CONTENTS](#)

# WHAT'S IN THE BOX?

Congratulations on the purchase of your brand new LINX. Inside the box, you'll find each of the components required to get the system up and running for your next 4x4 adventure.

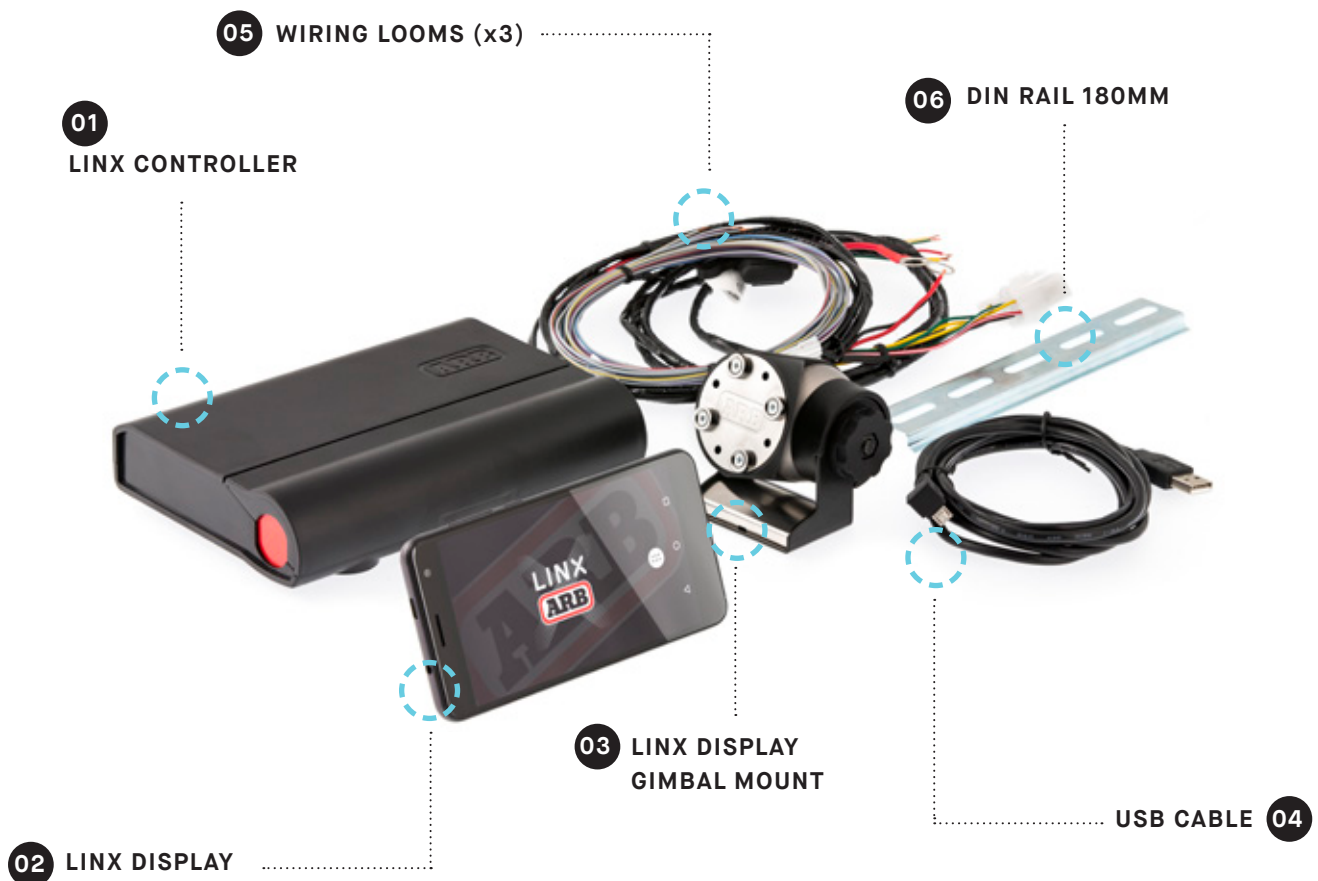

## NOTES

- The **LINX Display 02** was specifically designed to withstand the extremes of heat and cold. It has a metal coupling on the back to connect it to the magnets on the **LINX Display Gimbal Mount 03**.
- The **LINX Controller 01** and **wiring looms 05** are normally mounted under the dash, however this may vary depending on the vehicle.
- The **DIN rail 06** comes assembled to the back of the **LINX controller 01** and is used for securing the unit.
- The USB connection can be used to power and charge the LINX Display, and provide the communications channel between the LINX Controller and LINX Display.



# OVERVIEW

Out of the box, LINX offers total control of six pre-installed modules: Front & Rear Traction, Compressor & Pressure Control, Battery Monitoring, Speedometer, Air Suspension Control and an Accessory Switchboard.

[BACK TO TABLE OF CONTENTS](#)



# COMPATIBLE ARB ACCESSORIES

There's a range of ARB accessories that can be controlled and monitored by LINX.



## ARB DRIVING LIGHTS

ARB offers a large range of LED, HID and Halogen driving lights and light bars to suit your every driving need. Designed to perform in the most extreme conditions, they'll keep the road ahead brightly lit and the rear visible wherever you go.



## AIR LOCKERS

Designed and manufactured in Australia, ARB Air Lockers will enhance the traction of your 4x4 in just about any terrain, whether it's rock, clay, gravel, sand, snow or mud.



## ARB DUAL BATTERY SYSTEMS

Allowing you to power additional accessories without the risk of flattening the main battery, an ARB Dual Battery System also provides peace of mind in the event of a main battery failure.



## ARB AIR COMPRESSORS

ARB Air Compressors provide many advantages; including inflating tyres and camping accessories, running air tools, activating Air Lockers and even re-seating a tyre onto a wheel.

# OPTIONAL ACCESSORIES

A range of products are available to complement the LINX Vehicle Accessory Interface.

Please refer to the LINX Installation Guide or your nearest ARB Store or Stockist for further information.

FIND YOUR NEAREST STORE



## A-PILLAR BRACKET

LINX A-Pillar Brackets are designed to provide a vehicle specific mount that puts the LINX Display in safe and easy reach of the driver. They are available for a large range of popular 4WD vehicles.





**PRESSURE CONTROL KIT**  
(7450107)

Offering 'set & forget' simplicity to either tyre inflation or remote control over your air suspension, the optional LINX Pressure Control Kit (coupled with an ARB air compressor) allows you to take full advantage of LINX's Pressure Control Module.

**Note:** Separate pressure control kits are required for tyre inflation and air suspension.



**RELAY KIT**  
(180422)

A pre-wired relay base used for connecting accessories that don't come with a relay in its wiring loom. Most ARB wiring looms already come with a relay.



**AIR SUSPENSION ISOLATION KIT**  
(7450109)

Adding an Air Suspension Isolation Kit allows owners with air suspension to take full advantage of LINX's Air Suspension Module, providing the ability to independently adjust the pressure and ride height in each air bag.



**LINX TERMINAL KIT**  
(7450105)

LINX already comes with a packet of terminals, enough to do a complete install. This kit is if you require any extra terminals.



# INITIAL SETUP

It's time to get your LINX device up and running!

[BACK TO TABLE OF CONTENTS](#)

# 04 SETTING UP YOUR LINX

The time taken to connect and configure accessories such as compressor, Air Lockers and driving lights will vary depending on whether the accessory was fitted before or after your next LINX installation. LINX is fully customisable to suit your vehicle, please contact your local ARB distributor to discuss your individual requirements and provide a quote for your installation.



## LINX SETUP PROCESS

- Mounting of the LINX Controller.
- Connection of the power loom to the LINX Controller.
- Updating LINX software.
- Connection of 4 input wires from accessory power, parker/low beam headlamps, high beam headlamps and reverse lamp to the LINX Controller.
- Installation of the LINX Display Gimbal Mount and/or optional vehicle specific LINX A-Pillar Bracket.
- Connection of the USB cable from the LINX Controller or optional USB power source to the LINX Display.

# GETTING STARTED

The LINX Display receives power from the LINX Controller via the USB charge cable provided.

The LINX Display's on-board battery will take around 1 hour to fully charge from flat condition and provide approximately 4 hours of non-connected run time. It is normal practice to leave the display on all the time and connected when in the vehicle. When outside the vehicle, the display communicates with the LINX Controller via a Bluetooth connection up to 10m away.



## SWITCHING ON/OFF

To switch on the Display, press & hold the **power button 06** for approximately two (2) seconds.

With the unit powered on, you can increase or decrease the volume by pressing the **volume buttons 07**

To switch off the Display, press & hold the power button then tap **Power off** then **OK**.

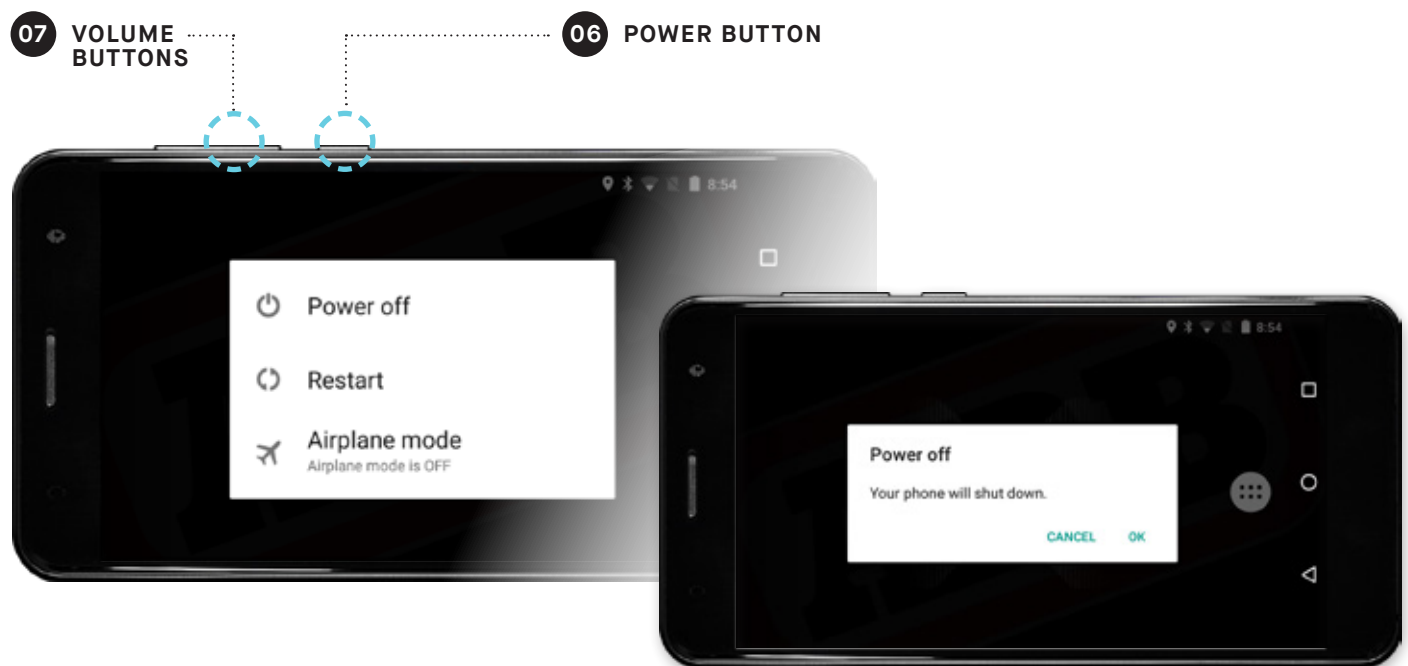

For more information on installing the LINX system and associated equipment on your vehicle, please refer to the LINX Installation Guide and your nearest ARB outlet.

## UPDATING LINX SOFTWARE

Once the LINX Controller has been connected to power it is important to check for and perform a LINX software update before doing any further wiring.

To do this, you will need to turn on the LINX Display, connect to the internet (via wifi for mobile data) and then connect to the LINX Controller using the provided USB cable.

The LINX Display may take up to 1 minute to turn on and start the LINX App. When it starts you may briefly see the 'connecting screen' shown below.

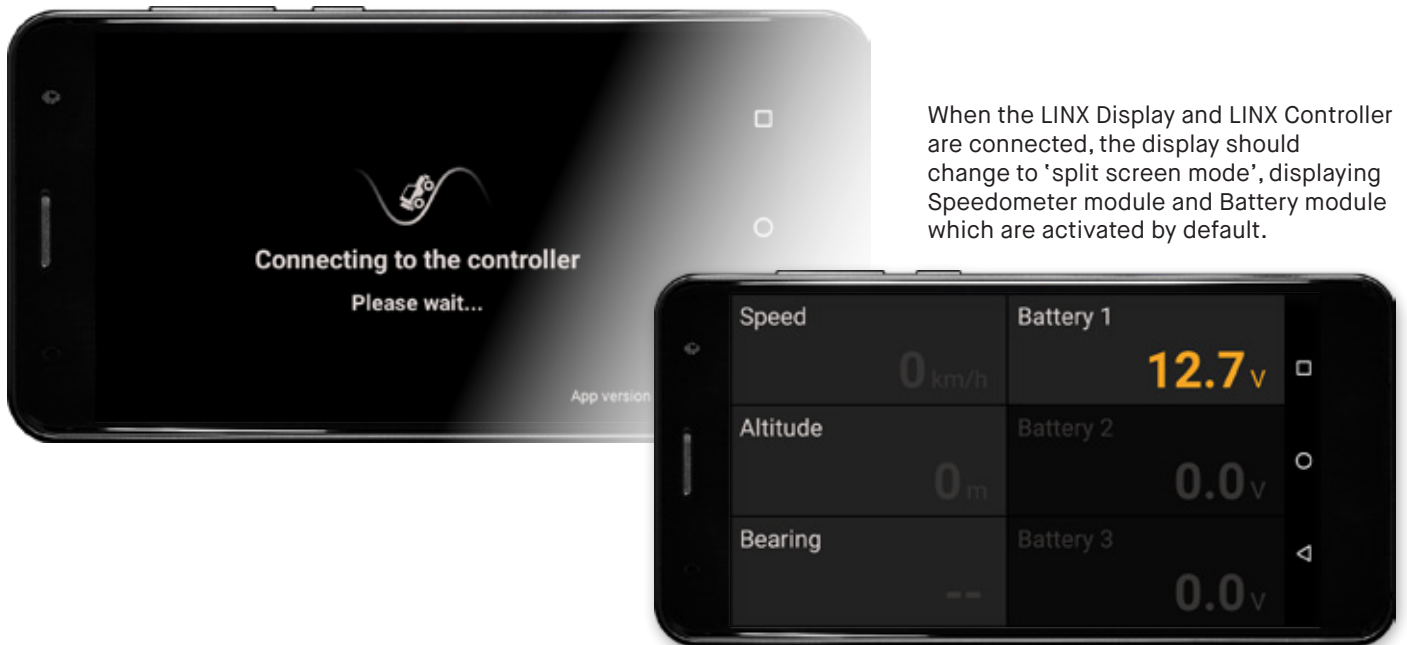

Swipe from left to right across the screen to show the LINX Main Icon Screen. Then tap on the **settings** icon.





1. Upon selecting **LINX Update** the screen will display:



2. If a new version is available, tap **Download** and follow the instructions to install.



When LINX re-connects after the update, it will determine if the LINX Controller firmware also needs to be updated and show the following screen. Tap **Update Now** and follow the instructions.



## BLUETOOTH PAIRING THE DISPLAY WITH CONTROLLER

---

The LINX Display and LINX Controller can communicate using either the USB or Bluetooth connection. But before Bluetooth communication can be used, first they have to be paired.

### AUTO PAIRING

The easiest way to pair the display and controller is to first connect them via USB and perform a software update as described in the section above. Then simply unplug the USB cable and when the LINX Display will request permission to pair, as shown below.

Tap **PAIR** to accept the pairing. The LINX Display and LINX Controller are now paired and will connect via Bluetooth whenever in range.



**Note:** Once the LINX Display and LINX Controller have been Bluetooth paired, the LINX Controller will become invisible to all other Bluetooth devices. The LINX Controller Bluetooth visibility can only be reset by resetting the LINX Controller, by disconnecting/reconnecting it to power.

### MANUAL PAIRING

If the LINX system installation is already complete and USB cable hasn't been used to connect the LINX Display and LINX Controller, and the LINX Controller is difficult to access, then the display and controller can be manually paired via the Bluetooth settings.

Access the **BLUETOOTH SETTINGS** by:

1. Open up the **APP DRAWER**



2. Tap **SETTINGS** and select **BLUETOOTH**

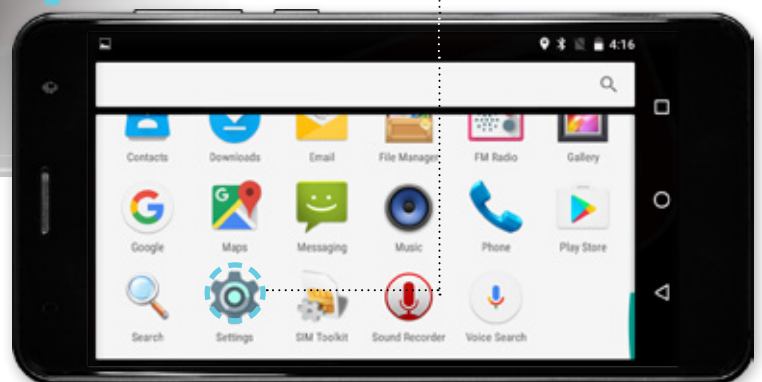

To pair with LINX:

1. Tap 'ARB LINX' from the available devices.

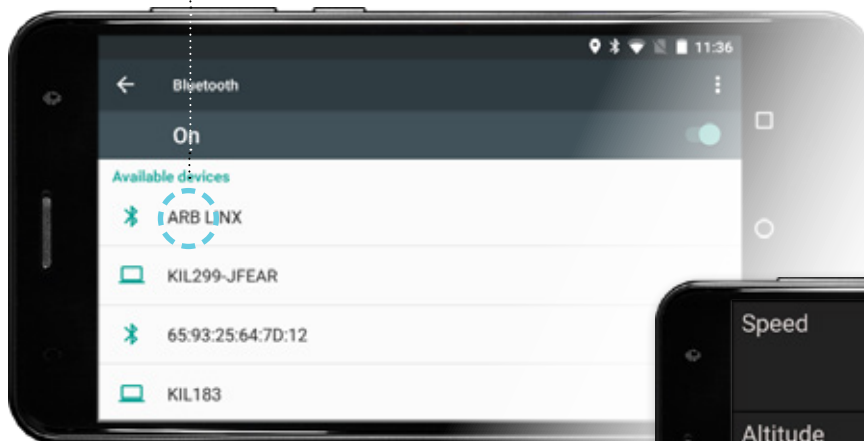

2. Once paired, the LINX Display should change to 'split screen mode', and be displaying the vehicle's battery voltage





# OPERATING LINX

Learn how to navigate your LINX device.

[BACK TO TABLE OF CONTENTS](#)

# LINX DISPLAY

The LINX Display is the user interface that enables the driver to access and customise the settings that control the 4X4 equipment installed on the vehicle and connected to the LINX Controller.

It uses a capacitive touch screen and is based on the Android 6.0 operating system. It has been designed to withstand the rigor of 4x4 driving including operating temperatures from -20°C to 80°C.

The LINX Display supports USB, Bluetooth, WiFi and GPS connectivity and complies with FCC, CE and RCM certifications.

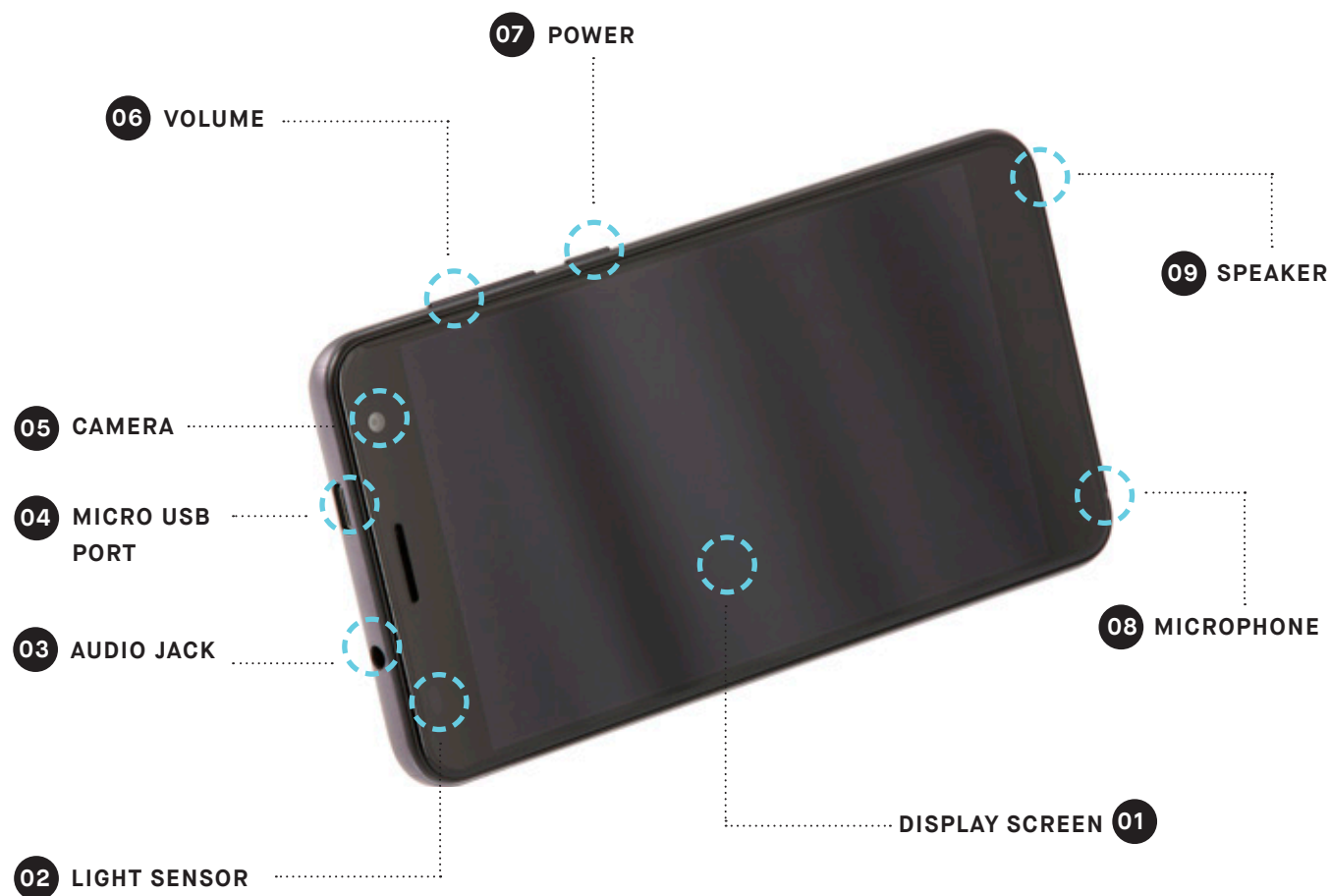

# HOME SCREEN

Upon start-up, the LINX Display shows the ARB LINX home screen and then enters 'split screen mode'.

The status bar contains several icons positioned across the top of the display which indicate the status of the unit. Items which are active/on are bright. Items which are inactive/off are greyed out.

Settings that should remain on all the time include GPS (for the LINX Speedometer module to operate), Bluetooth (for LINX Controller communications when the LINX Display is disconnected from the USB cable) and WiFi as this is used by the LINX Display to communicate with the Internet during LINX updates.



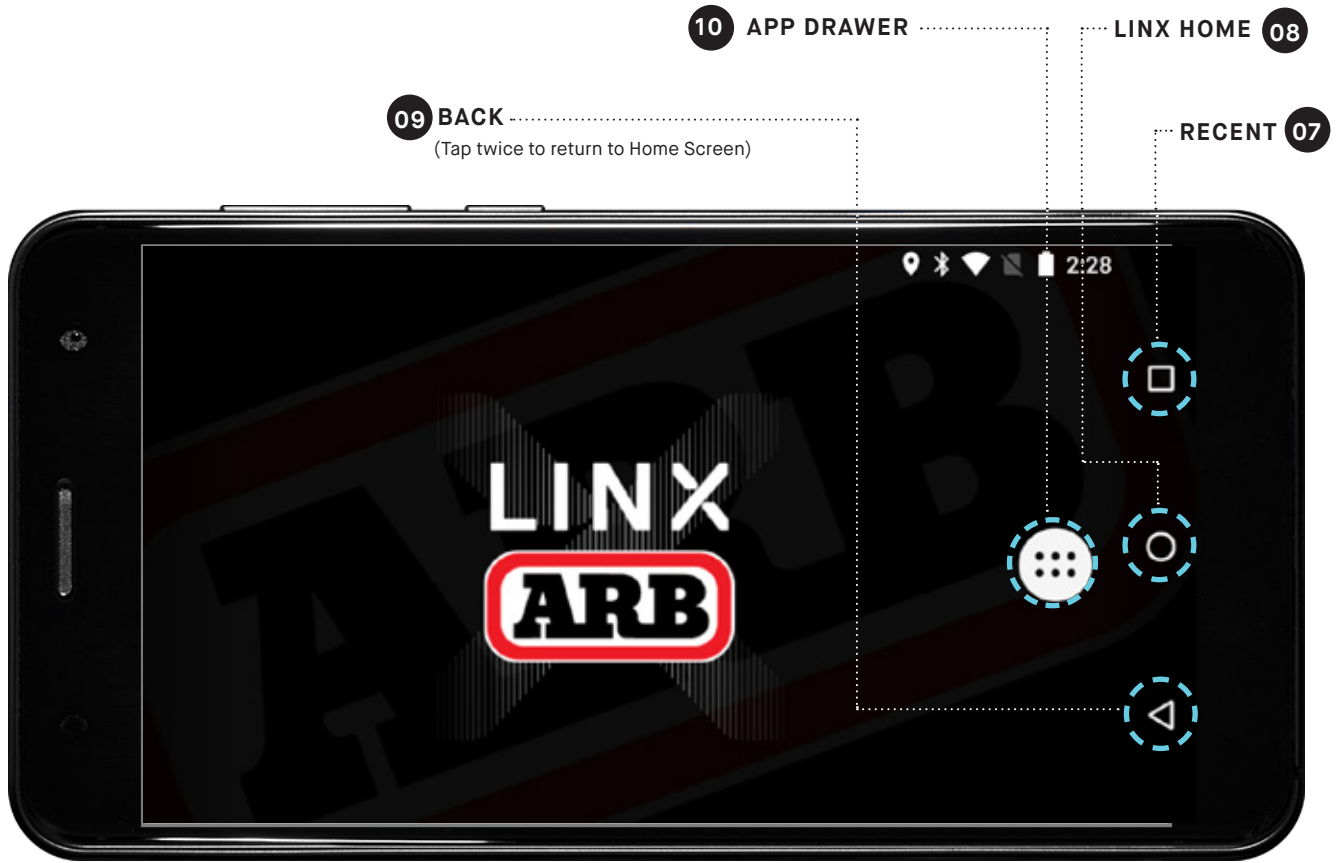

## NOTES

- Tap **Recent** **07** to display a list of recently selected Apps. Scroll up/down and tap an item to return to it. To remove an item from the list tap the X button for that item.
- Tap **APP drawer** **10** to display all Apps installed on your LINX Display.
- Tap **LINX home** **08** to return to the LINX home screen.
- Tap **Back** **09** to return to the previous screen. (When in LINX 'split screen mode', tap and hold **L2** to save the current module view as Favourite. To show the Favourite view at any time, tap **Back** **09** again.

# SETTINGS MENUS

## QUICK SETTINGS MENU

Quick Settings is used to change frequently accessed items. With two fingers, swipe down from the top of the screen to open the Quick Settings menu. To toggle something on or off, simply tap the appropriate icon.



## MAIN SETTINGS MENU

The Main Settings menu is used to control core Android settings. To open, tap the settings icon at the top right of the Quick Settings menu. Alternatively, from the Home Screen, tap **App drawer**, then tap **Settings** from the list. Swipe up or down to view setting options. Tap an item to select it. Tap **Back** to return to the previous menu, or **Home** to return to the LINX home screen.

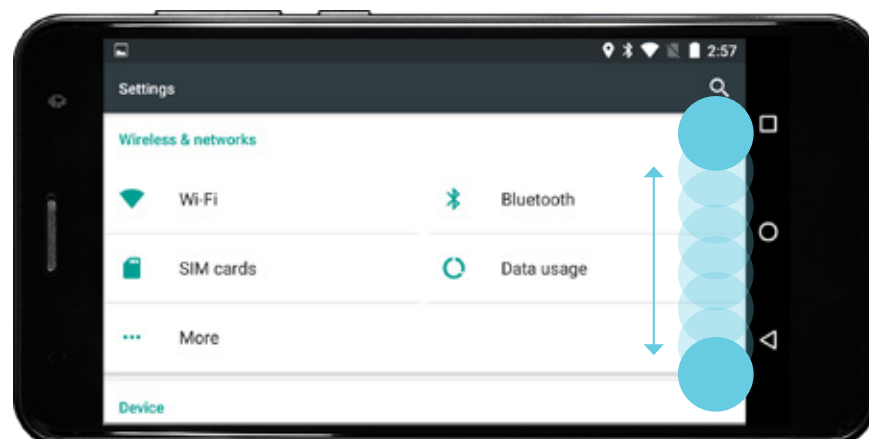



# LINX USER INTERFACE

The LINX system offers a Graphical User Interface (GUI) similar to that found on most smart phones and tablets.

In order to fast track your use of the LINX interface, please acquaint yourself with these basic methods of interacting with LINX.



**SINGLE TAP** a module or button to select it or turn it on/off.



**DOUBLE TAP** a module to toggle between full / split screen display.



**PRESS & HOLD** a module for 2 second to go to its settings menu, or to edit an underlined value or text.



**PRESS & HOLD** switchover buttons for momentary contact switching.

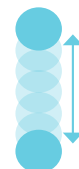

**SWIPE UP/DOWN** in split screen mode with one finger to scroll to the next Module.



**SWIPE LEFT/RIGHT** in 'split screen mode' to return to the LINX Main Icon Screen.

## BUTTON COLOUR STATUS

SELECTABLE  
(but turned off)



SELECTABLE  
(and turned on)

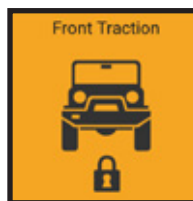

NON-SELECTABLE  
(disabled)



**AUTOMATION TRIANGLE** on a button indicates a LINX automated state of the control.



**THEMED COLOURED VALUE** is a real-time display, as opposed to a set value.



## LINX DISPLAY SCREENS

### MAIN ICON SCREEN



**SPLIT SCREEN**  
(independently scroll)



### FULL SCREEN



**TEXT ENTRY**

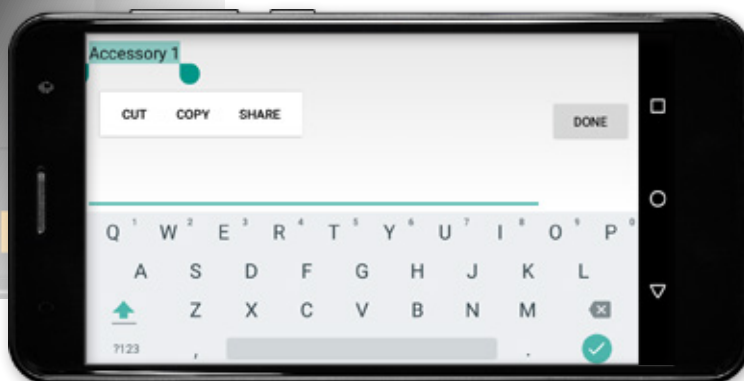

### NUMERIC ENTRY



**INFORMATION SCREEN**



# LINX MAIN ICON SCREEN

The LINX Main Icon Screen contains a list of the software modules installed on your LINX Display. It provides direct access to each of the LINX modules, the LINX settings, LINX module activation and LINX system information.

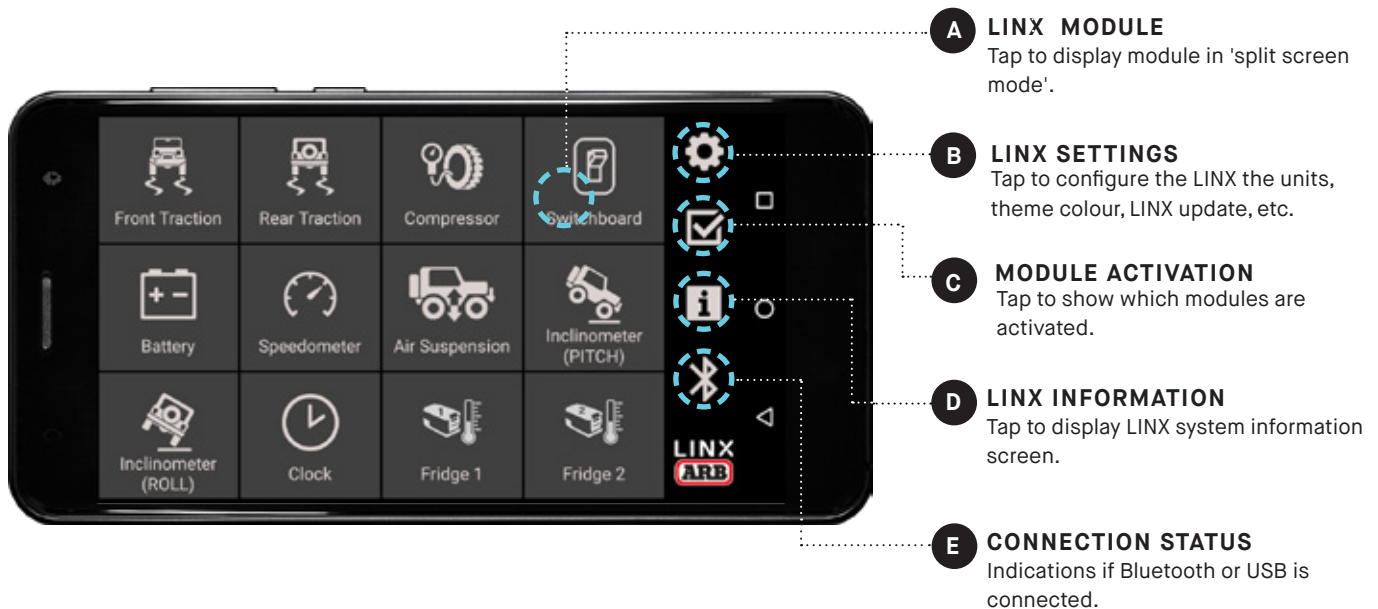

LINX information screen contains the LINX systems software versions and disclaimer.



## ACCESSING EACH MODULE

The LINX Display is supplied with pre-installed software modules. These provide access to modules like: Front and Rear Traction, Compressor, Switchboard (for lights), Battery monitor, Speedometer and Air Suspension.

Scroll down or up to see which modules are installed.



When a module is selected, the display automatically enters 'split screen mode'. The screen is then divided into two columns. Each screen can then be scrolled vertically independent of the other.

## RETURNING TO LINX MAIN ICON SCREEN

Access to the LINX Main Icon Screen is gained by swiping left or right from 'split screen mode'.



## LINX SETTINGS SCREEN

The LINX system's **Auto Night Mode** integrates with the vehicles headlights and enables the user to customise the display brightness for specific driving conditions. The **Units** for speed, distance, temperature and pressure can also be set individually. The interface **Theme Colour** may be adjusted and a **LINX Update** will update the LINX software to ensure the system is running the latest version of LINX (**Note:** Run a LINX Update when first installed).

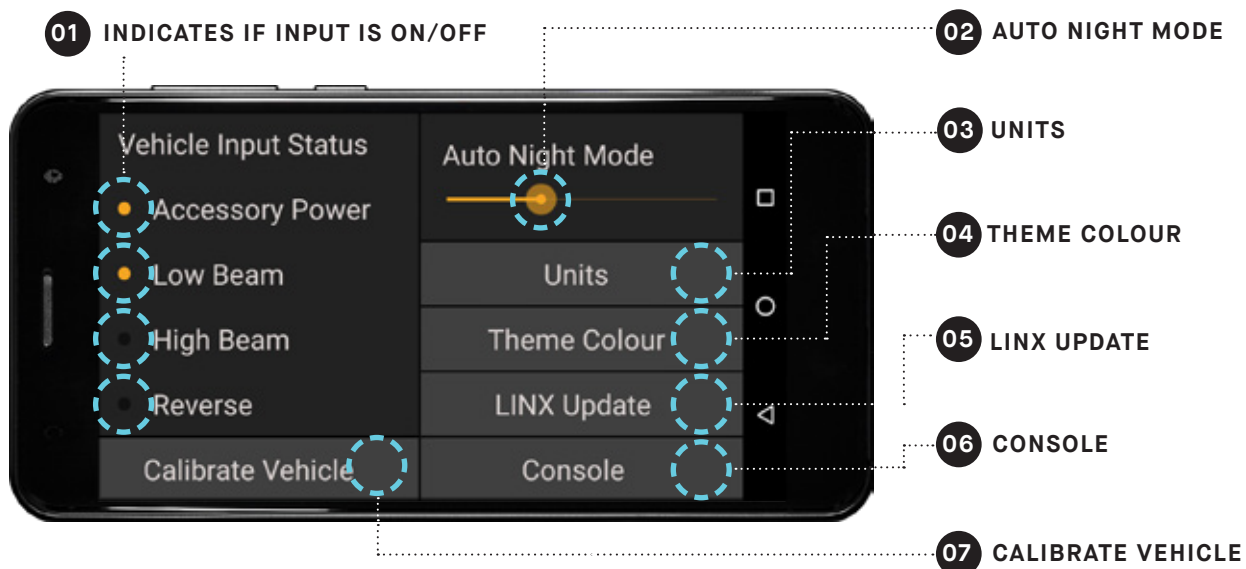

### UNITS SELECTION SCREEN



### THEME COLOUR SCREEN



## NOTES

- The **Vehicle Input Status** area **01** will show a coloured dot next to activated input connections on the controller.
- Use the slide control on **Auto Night Mode** **02** to customise the brightness level of the LINX Display for a specific driving condition. E.g. For night driving you may want to switch your low beam lights on, then adjust the brightness down to a level you want active when the low beam lights are next in operation.
- Tap **Units** **03** to bring up the units menu and tap the combination of units required.
- Tap **Theme Colour** **04**. Press and drag or slide to match your vehicle's instrumentation colours.
- Run a **LINX Update** **05** to check if you have the latest software build and features on your device.
- Tap the **Console** button **06** to enter configuration commands.
- Tap **Calibrate Vehicle** **07** then follow the instructions to calibrate the controllers orientation within the vehicle.

# UPDATING LINX

The LINX system can check for new updates whenever connected to the Internet by tapping 'LINX Update'.

1. Upon selecting **LINX Update** the screen will display:



2. If a new version is available, tap **Download** and follow the instructions to install.

When LINX re-connects after the update, it will determine if the LINX Controller firmware also needs to be updated and show the following screen. Tap **Update Now** and follow the instructions.





# MODULES OVERVIEW

When you're ready to hit the road, accessing each module using LINX is achieved with a simple swipe across the touchscreen display.

[BACK TO TABLE OF CONTENTS](#)

# FRONT AND REAR TRACTION MODULES

The LINX Front Traction and Rear Traction modules are used to control and setup the Air Lockers installed on your vehicle and when selected will automatically turn on the air compressor where required to engage them.

1. Double tapping the **Front Traction** (or Rear Traction) module brings up 'full screen mode' for the Traction module.

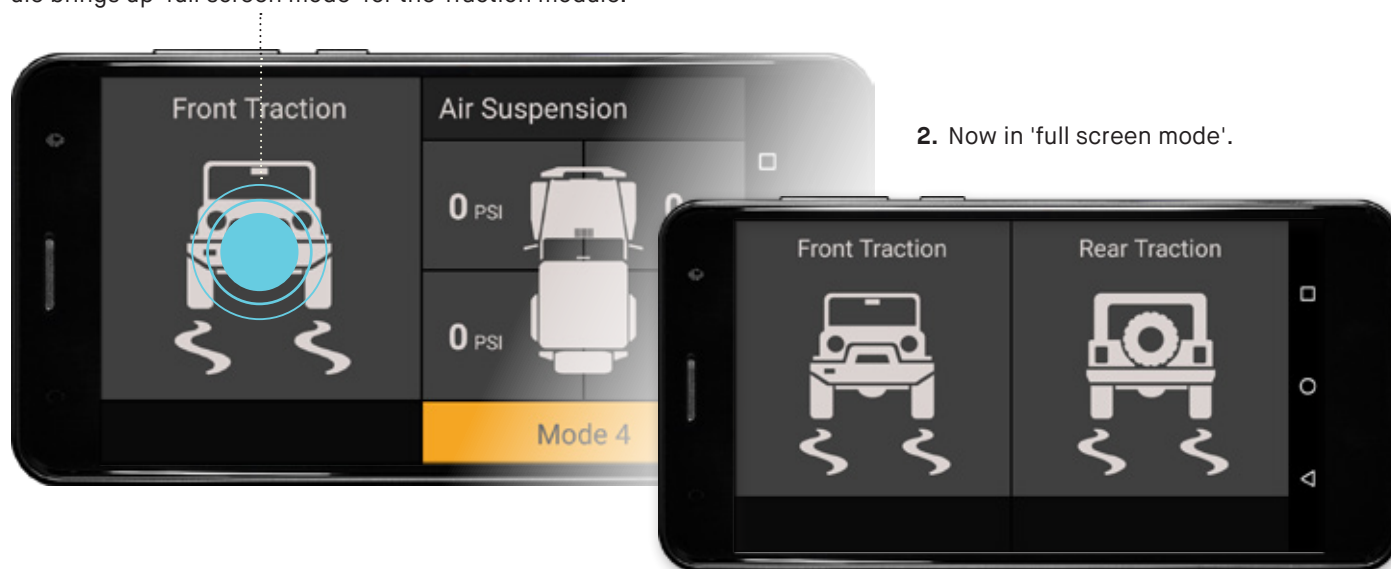

2. Now in 'full screen mode'.

To engage the rear Air Locker, simply tap the button once. Tap again to switch off the rear Air Locker.

1. Single tap on **Rear Traction**.

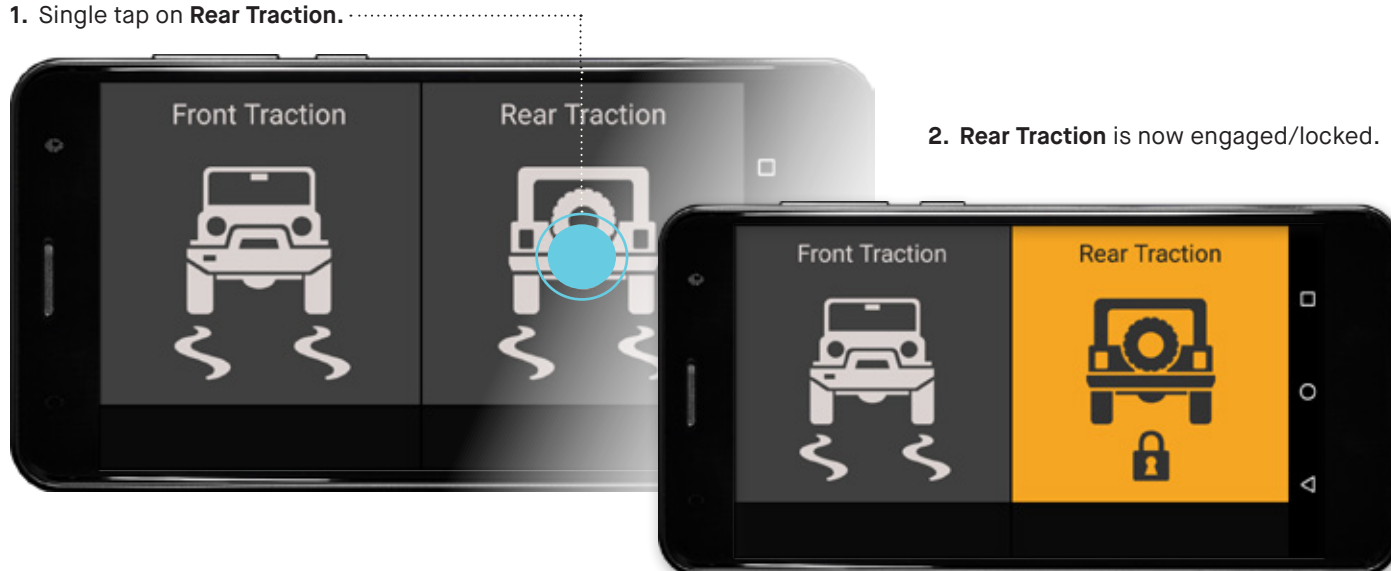

2. **Rear Traction** is now engaged/locked.



## CONFIGURING TRACTION MODULES: AIR LOCKER SETUP

To enter settings for the Traction modules, press and hold the module. This will show the traction settings page. Simply tap the option you wish to set. Tap again to unset it.

### 1. Press and hold **Front Traction**



2. Front Traction settings page. **Front Axle Second** is selected by default.

The Front Traction module can be setup to operate in two ways: 'front axle second', and 'front independent of rear'.

### FRONT AXLE SECOND

'Front axle second' is the default mode in which the LINX system is supplied. It automatically greys-out the **Front Traction** button making it unselectable until the **Rear Traction** button is made active. This is a traditional safety feature of Air Lockers that was factory hard wired in conventional installations.



### FRONT INDEPENDENT OF REAR

'Front independent of rear' mode is available when **Front Axle Second** is deselected. It allows the front and/or rear Air Lockers to be switched on or off independently of the other at any time.



### EXTERNAL LOCK SWITCH INSTALLED

When **External Lock Switch** is selected, this allows you to control the Traction module with an Air Locker dashboard switch. LINX will display the lock / unlock state of the dashboard switch and the LINX Display button will be unselectable.

### TRACTION LAYOUT OPTIONS

When **Combined** is selected, both the Front and Rear Traction buttons will be combined onto one tile (if they are both installed). This reduces each traction button size but frees up the other half of the display for another module.

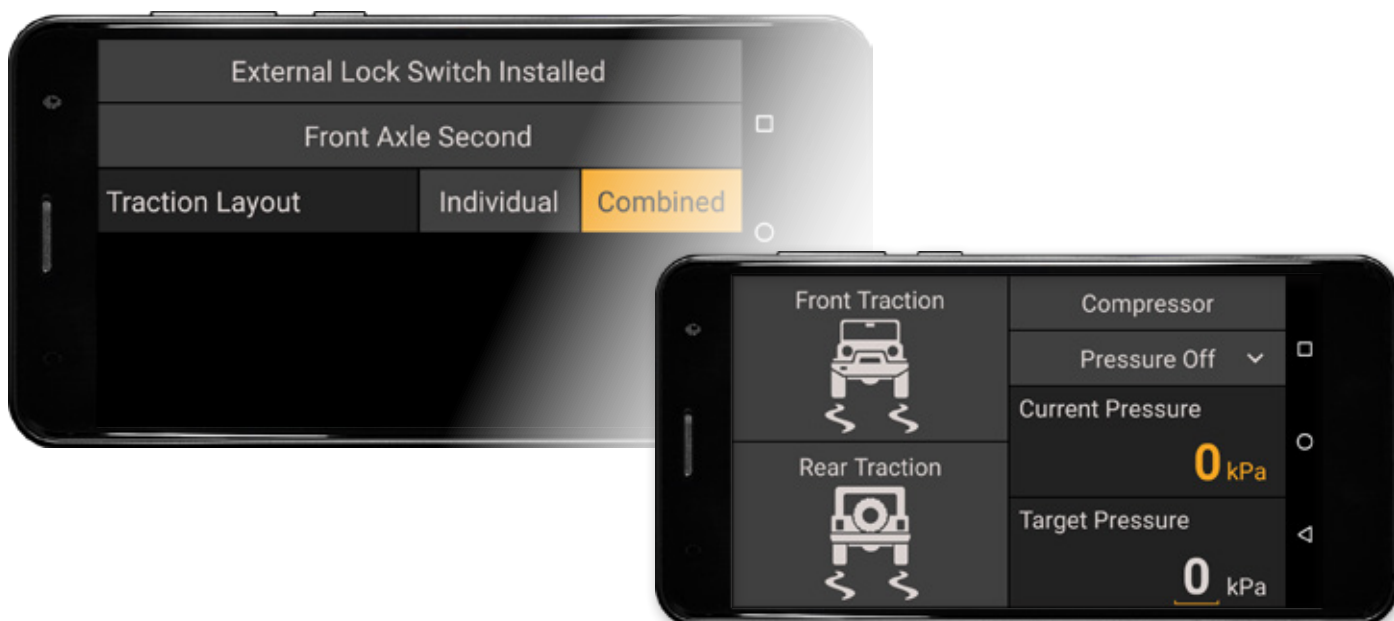

# COMPRESSOR MODULE

## AND OPTIONAL PRESSURE CONTROL MODULE

The LINX Compressor module is used to configure and operate your air compressor. 'Pressure Control' is an optional upgrade that is used in conjunction with the LINX Pressure Control Kit (7450107) to inflate or deflate your tyres to a target pressure.

### SWITCHING ON COMPRESSOR

To switch the **Compressor** on, tap the button once. Tap again to switch it off.  
Note: Vehicle accessory power must be on before Compressor can be turned on.

1. Single tap on **Compressor** button.



2. **Compressor** highlighted indicates it is on.

The blue automation triangle appears in the top right corner of the Compressor button to indicate that LINX has changed the state of the Compressor, such as the vehicles accessory power turning off, or Front Traction turning on.



## CONFIGURING COMPRESSOR MODULE

To configure the Compressor module, press and hold anywhere on the module, this will show the compressor settings page. Tap the option you wish to set. Tap again to unset it.

1. Press and hold anywhere on the Compressor module.



2. Compressor settings page (**Allow Only if Engine Running** is set by default)

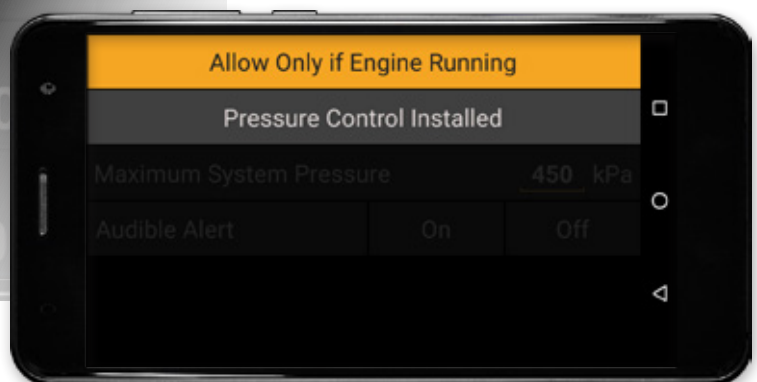

'Allow Only if Engine Running' ensures that the compressor will only run when the voltage is 12.8V or more, this prevents any damage to the compressor motor or blown fuses if the battery levels are too low to operate it.

## CONFIGURING PRESSURE CONTROL

To activate the optional Pressure Control feature, tap the **Pressure Control Installed** button then set the **Maximum System Pressure** to set the upper limit that can be used when inflating your items.

This must be less than the minimum limit of your compressor's pressure switch (e.g. For an ARB C035 100psi pressure switch set it to 65psi, for an ARB 180901 150psi pressure switch set it to 130 psi).

1. Tap **Pressure Control Installed**



2. Then set the **Maximum System Pressure**

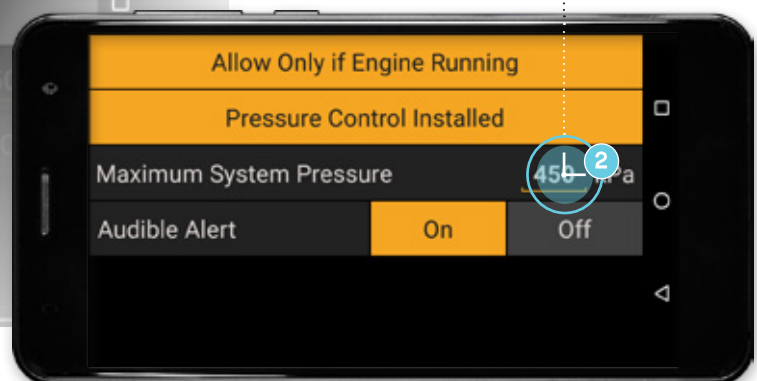

Turn on the **Audible Alert** and a chime will sound when inflation or deflation is complete. Simply tap the **On** or **Off** buttons to turn it on or off.

Tap **Back** to return to 'split screen mode'. The Display will now show the **Current Pressure** in the air line connected to the Pressure Control Kit, and user definable **Target Pressure**.

1. To change the **Target Pressure** press & hold the underlined value '33' to bring up the keypad entry.



2. Use the keypad to input the required value, then tap the **tick** to set it.



## PRESSURE CONTROL MODE LIST

With pressure control installed the Current Pressure and Target Pressure fields are activated along with the **Pressure Control Mode** list. Tap on the dropdown list to select from the 3 different modes.

1. Tap the 'dropdown list' to view the list of modes.



### PRESSURE CONTROL MODES

**Pressure Off** means no air flow from the compressor, but residual pressure may still be in the air line.

**Pressure Control** will turn on the compressor and the Pressure Control Valve will try to inflate/deflate to achieve the **Target Pressure** to a value less than or equal to the **Maximum System Pressure** setting.

**Pressure Max** will turn on the compressor, and open the Pressure Control Valve, thereby opening up a straight connection between the compressor and air line which is useful when using a blow gun on the air line.

**Cancel** is used to back out of the menu (ie same as tapping the **Back** button).

## NOTES

- Parameters that may be set by the user are shown underlined.
- Theme coloured parameters (e.g. **Current Pressure** value) are monitored by the system.
- The **Maximum System Pressure** will automatically override any **Target Pressure** entered in excess of it.
- **Current Pressure** is the pressure monitored by the LINX system in whatever is connected to the LINX Pressure control Kit.
- **Target Pressure** is the pressure that the user may set to either inflate or deflate their tyres.
- The LINX Display uses Bluetooth to communicate with the LINX Controller and may be disconnected from the USB cable then removed from the mount and taken outside of the vehicle to monitor and control your tyre pressures dynamically at the side of your vehicle.

## WARNING

Tyre pressures vary by manufacturer, type, vehicle load, speed and driving conditions. Over inflating your tyres can lead to excessive tread wear and shorten their overall life expectancy. Please consult the tyre manufacturer for the appropriate pressure settings for your tyres and driving conditions. Always remember to re-inflate your tyres to the correct pressure immediately upon returning to sealed roads. Failure to do so could seriously affect vehicle handling and possibly result in tyre failure

# SWITCHBOARD MODULE

The LINX Switchboard module can be used to control up to six (6) optional switched accessories connected to your LINX Controller.

Each accessory can be given a unique name (up to 16 characters) and then be customised to switch on or off; by user input, or an one of the 'vehicle inputs': accessory power, parker/low beam headlamps, high beam headlamps or reverse lamp.

They can also be turned off automatically when a user defined setting for low voltage cut out has been detected by LINX to protect your vehicle from a flat battery. All settings are saved back to the LINX Controller and remain active 24/7 even if the LINX Display is off or is removed from the vehicle.

## CONFIGURING SWITCHBOARD MODULE

1. Press and hold on an individual accessory button to show its settings page.

2. Tap the checkbox in the right hand corner to activate the accessory.





## RENAMING ACCESSORIES

To rename 'Accessory 1' to suit your vehicle accessory setup:

1. Press and hold the underlined text to show the keyboard.

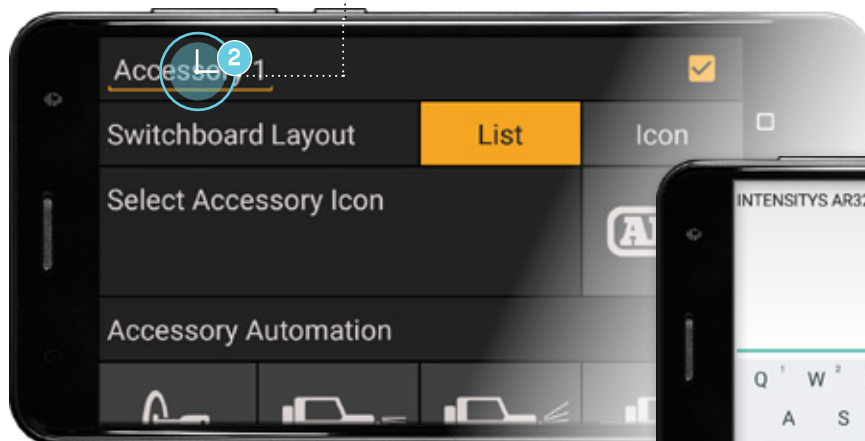

2. Then, enter a name relating to its function and tap **DONE** when complete.



**E.g.** To setup your front flood or spot lights you could enter 'INTENSITYS AR32'

## SWITCHBOARD LAYOUT OPTIONS

There are two layout choices for the switchboard. There is a 1 x 6 button list layout, and there is also a 2 x 3 square icon button layout.



To select between the layout options tap the **List** or **Icon** button in the setting page of any accessory. Then the icon graphic for each accessory is selected in the each accessories settings page.

1. First tap the button with the icon graphic.....



2. Tap the desired icon for the that accessory. Repeat for each accessory button.



## AUTOMATING ACCESSORIES

To automate the 'INTENSITYS AR32' to turn on or off with the vehicle's high beams, simply tap the **high beam** button in the **Accessory Automation** menu.

1. Tap the **high beam** button to select it. ....



2. The button will change colour when selected.

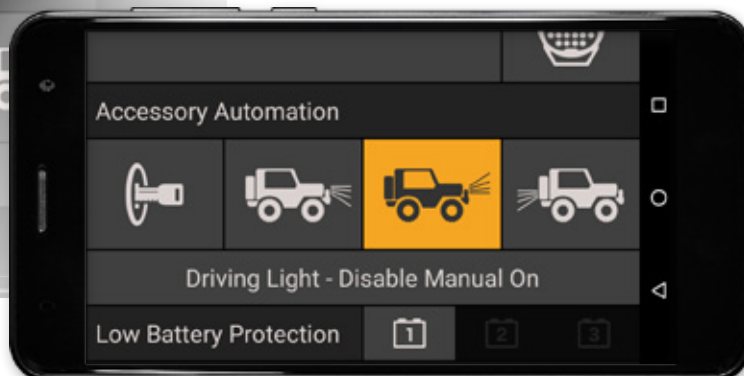

All automation functions are user over-ridable by default. For instance LINX might automate the 'INTENSITY AR32' to come on whenever the high beams turn on, but the user can switch the 'INTENSITY AR32' off at any time. However in some jurisdictions, when the accessory being controlled is a driving light, it is only allowed to be turned on with high beams, in this case tap **Driving Light - Disable Manual On** - **Disable Manual On** to select it.

1. Tap the **Driving Light - Disable Manual On** button to select it.



2. The button will change colour when selected.

### LOW BATTERY PROTECTION

To assign **Low Battery Protection** to switch off the 'INTENSITYS AR32' based on **Battery 1's** set **Low Voltage Alarm** level:

Tap the **Battery 1** button to activate it.



(Refer to the section on the Battery module for customising the battery settings and entering a **Low Voltage Alarm** level)

### NOTE

- In the example shown above, the **Low Battery Protection** on **Battery 1** will ensure that the 'INTENSITYS AR32' are switched off (even though your high beam lamps are still switched on) once the battery level drops below limit set by **Low Voltage Alarm** in the Battery module settings.

### VEHICLE OFF COURTESY LIGHT TIMER

The courtesy Light feature will turn on the accessory for a set period of time when the vehicle turns off (when LINX ACC input turns off). With the timer value to 0 the feature is inactive. To activate the courtesy light feature simply set the **Vehicle Off Courtesy Light Timer** to a value greater than 0.



### ALLOW ON WHEN VEHICLE OFF

By default switchboard accessories are not allowed to be turned on, and will be switched off, when the vehicle is turned off (when LINX ACC input is off). To allow an accessory to be turned on at any time, tap the **Allow On When Vehicle Off** button to select it.

## INTENSITY SOLIS CONFIGURATION

When **Enable ARB Intensity SOLIS Functions** is selected, a range of brightness controls can be configured specifically for Intensity Solis. It also auto-selects and mandates the Intensity Solis icon.

**Fade rate** sets the rate at which the brightness changes as the Intensity Solis lights turn ON or OFF. Sliding the slider all the way to the right selects instantly.

**Single Setting** allows you to set one brightness for Intensity Solis for when it is turned ON manually or by high beams. Sliding the slider all the way to the right selects full brightness.

**Multi Modes** provides 4 modes, each of which the name and brightness can be personalised.

**Note:** When Intensity Solis is configured as **Multi Modes**, tapping the Intensity Solis button will show the list of modes to select from, and if no selection is made then LINX will toggle it ON/OFF if allowed to (check the **Driving Light - Disable Manual On** setting).

**Courtesy** brightness can be set individually. This relates to the **Vehicle Off Courtesy Light Timer** feature.

**DRL Enable** will turn on Intensity Solis whenever the vehicle ACC is ON. The DRL brightness can also be set individually, but it is recommended that it is set to the minimum which will only illuminate a small ring of LEDs in the centre of Intensity Solis.

**Recalibrate Minimum Brightness** adjusts the factory minimum brightness setting for all modes.

Tap the **Enable ARB Intensity SOLIS Functions** button to activate it.



Tap the **Multi Modes** button to reveal 4 brightness modes, each of which the name and brightness can be personalised. If the vehicle is turned ON, then the Intensity Solis will shine at the selected brightness in real time. When you close the settings page the Intensity Solis ON/OFF state or brightness mode will be restored.

Press and hold the underlined text to edit the mode names. Tap or slide to any position on the sliders to set the **Brightness**.

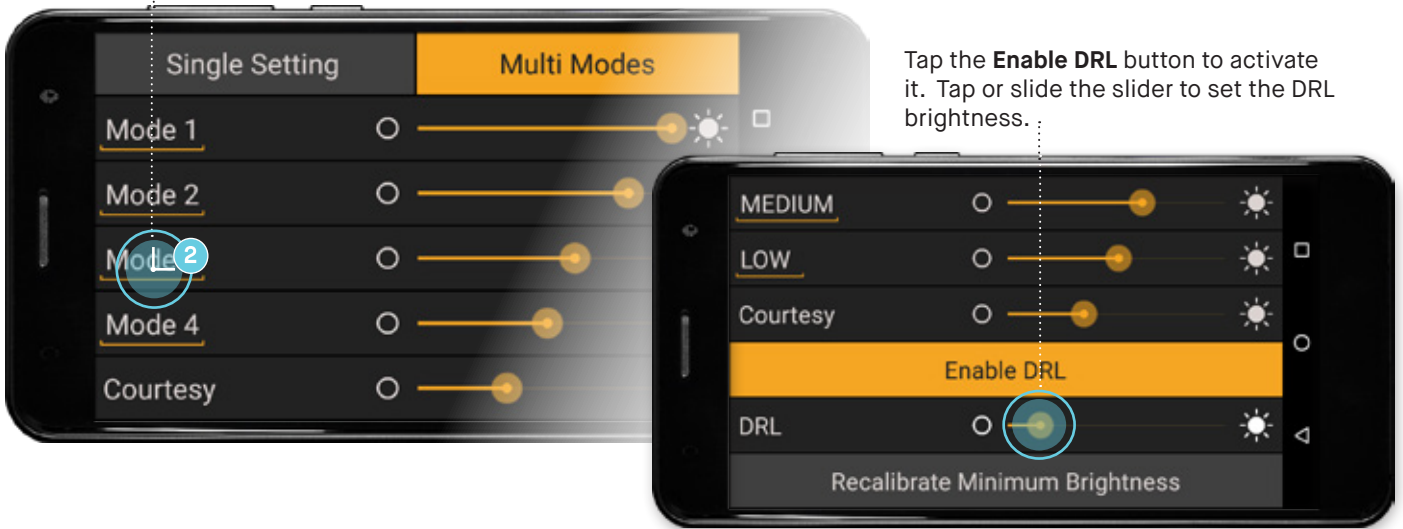

**Note:** DRL should only be enabled and used in accordance with all local regulations.

## SWITCHING ON/OFF AN ACCESSORY

To switch the accessory on, tap the button once. Tap again to switch off.



### INTENSITY SOLIS MULTI MODES

When an accessory is configured as Intensity Solis with Multi Modes, the ON/OFF behaviour is different.

When the button is tapped, the list of modes will be shown for a couple of seconds. If a new mode is selected then Intensity Solis will change to that mode.

However if no selection is made then the button will toggle from ON to OFF, or OFF to ON.

For example, if Intensity Solis is ON, and the button is tapped, the mode list will be shown and if no selection is made then it will turn OFF. However if Intensity Solis is OFF, then it will turn ON if allowed (check the **Driving Light - Disable Manual On** setting).

1. Tap the Intensity Solis button to change brightness mode, or turn OFF.



Brightness mode 2 was selected.



# BATTERY MODULE

The LINX Battery module can be used to monitor and display the charge state of up to three (3) independent batteries simultaneously.

Each battery can be given a unique name (up to 16 characters) and then be configured to operate with your Switchboard accessory via the Switchboard module. (Refer to the section on the Switchboard module for further details).

## CONFIGURING BATTERY MODULE

1. Press and hold **Battery 1** to show its settings page.



**Note:** The greyed-out checkbox indicates that **Battery 1** is the battery the LINX Controller is connected to for power. Hence it is active by default and cannot be de-activated.



## RENAMING BATTERIES

To rename 'Battery 1' to suit your vehicle accessory setup:

1. Press and hold the underlined text to show the keyboard.



2. Then, enter a name relating to its function, then tap **DONE**



**EXAMPLE:** To setup your main vehicle battery rename it to 'MAIN BATTERY'.

## SELECTING BATTERY TYPE

Select between **FLA** (Flooded Lead Acid) and **AGM** (Absorbed Glass Mat) battery type to enable battery charge level and predicted discharge curve in the battery fullscreen chart.



2. The button will change colour when selected.



### LOW VOLTAGE ALARM

To set the **Low Voltage Alarm** level:

1. Press & hold the underlined value '11.8' in the menu to bring up the keypad entry.



2. Then, use the keypad to input the required value then tap the tick to set it.



A **Low Voltage Alarm** when triggered will highlight in RED. For example, Battery 2 (renamed to "AUX BATTERY") has its **Low Voltage Alarm** level set to "11.5V" and the batteries actual voltage is 11.2V which now highlights in RED



Tap **BACK** return to Battery module screen.



### NOTES

- The maximum setting for **Low Voltage Alarm** and **Display Stop Charging** is 15.0V
- Parameters that may be set by the user are shown underlined (e.g. **Low Voltage Alarm** value).
- Higher **Display Stop Charging** values (e.g. 12.7) will reduce LINX power consumption when the vehicle is not used for long periods.
- Theme coloured parameters (e.g. battery voltage 12.7v) are displayed in real time.

## DISPLAY CHARGING

The LINX Controller can switch on and off the USB charging port, to maintain optimum LINX Display battery condition and charging efficiency, reducing LINX overall power consumption. Additionally when the vehicles battery voltage is below the the **Display Stop Charging** value, the LINX Controller will switch off the USB charging port to further reduce draw on the vehicle battery. To enable this feature:

1. Tap the **Batt Saver** button.



**Note:** Select **Always On** to disable this feature, and the USB charging port will remain always on.

## BATTERY MONITORING IN FULLSCREEN

The battery module in fullscreen contains a battery voltage history graph. When the battery type has been configured in settings, as Flooded Lead Acid (FLA) or Absorbed Glass Mat (AGM), then the battery monitor also estimates the battery level (state of charge) and shows a dashed line for the predicted battery discharge curve when there is a steady load/discharge.

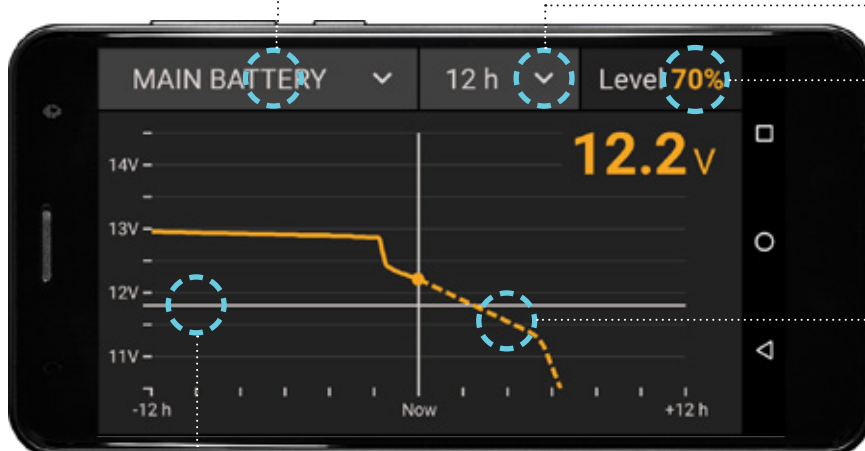

**A BATTERY SELECTION**  
Tap to select from a list of installed batteries.

**B TIME SCALE**  
Tap to select the time scale and view 6, 12 or 24 hours worth of battery voltage history.

**C LEVEL / STATE OF CHARGE**  
Displays the battery level when battery voltage is steady or under moderate discharge.

**D DISCHARGE CURVE**  
Dashed line show the predicted battery discharge curve when under steady discharge.

**E LOW VOLTAGE ALARM**  
The Low Voltage Alarm value configure for each battery is shown in the as the solid horizontal white line.

Single tap anywhere on the history graph (left side of the screen) to show the battery voltage data for that point in time.

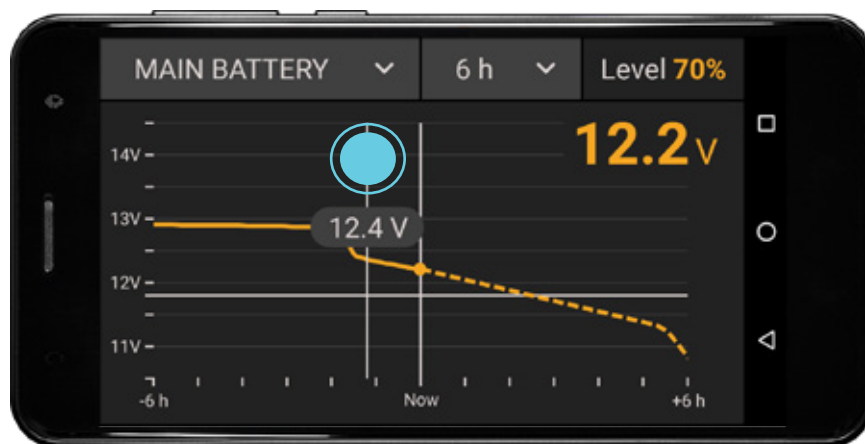

### NOTE

- It will take up to 10 minutes of steady discharge to calculate and show the battery **Level** and predicted discharge curve.

# SPEEDOMETER MODULE

The LINX Speedometer module works by GPS (Global Positioning System) to show the current speed, altitude and bearing of your vehicle.

The Speedometer module operates independently of tyre size or level of inflation of your tyres, thus providing better accuracy than an uncalibrated vehicle speedometer. The Speedometer module enables the user to assign a speed limit such that a warning is issued if the limit is exceeded by the driver. Greyed-out values indicate poor GPS reception.

## CONFIGURING SPEEDOMETER

1. Press and hold anywhere on the **Speed** display, to show its settings page. ....

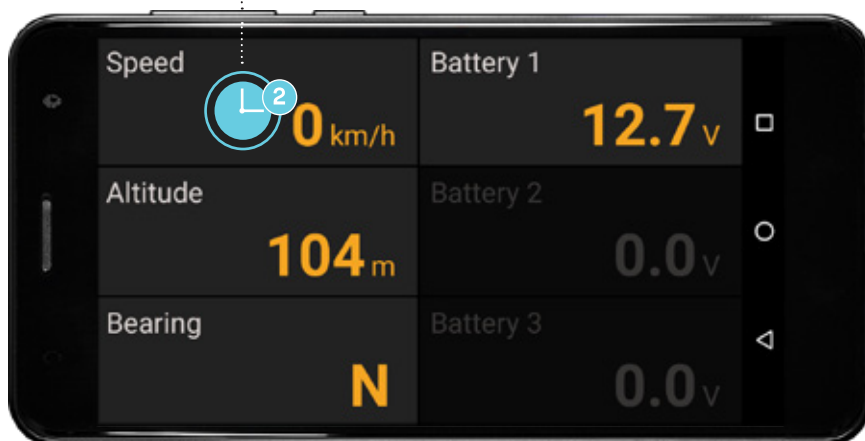

## SETTING SPEED LIMIT WARNING

To set the speed limit:

1. Press & hold the underlined value ('0 km/h') next to **Speed Limit Warning** to bring up the keypad entry.



1. Tap the tick box in the top right corner to activate the **Speed Limit Warning**.

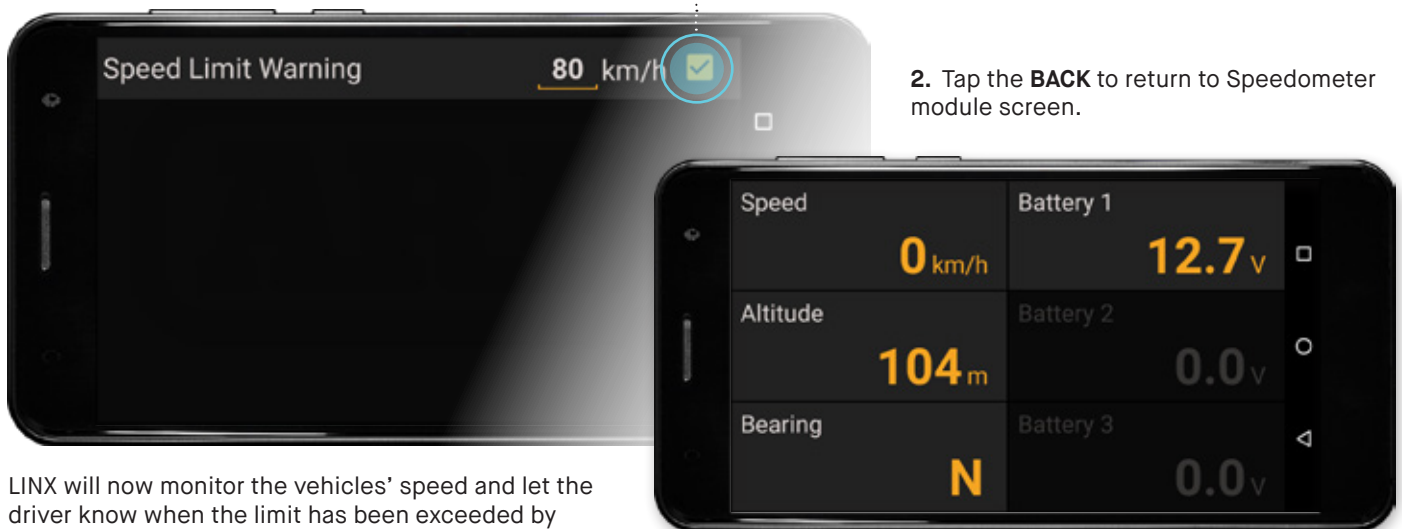

LINX will now monitor the vehicles' speed and let the driver know when the limit has been exceeded by changing the displayed speed colour to **RED**.

### NOTES

- Parameters that may be set by the user are shown underlined (e.g. **Speed Limit Warning** value).
- Theme coloured parameters (e.g. **Altitude**, **Bearing** and **Speed**) are monitored by the system.
- The GPS in your LINX Display requires good outdoor signal reception from at least three satellites to pinpoint your location for accuracy of operation. Greyed-out values indicate no GPS reception and are not real time (e.g. When driving through a tunnel).

# AIR SUSPENSION MODULE

The LINX Air Suspension module (when fitted with an optional compressor, airbags and LINX Pressure Control Kit 7450107) gives you the ability to control up to 4 airbags either as pairs to level the vehicle from front to rear, or independently to cater for uneven loads from one side to the other.

Independent air bag control requires the optional LINX Airbag Suspension Isolation Kit (7450109). The user can customise the pressure of the airbags then save these mode settings under unique names (up to 16 characters long) to suit different towing and vehicle load conditions then at the press of a button retrieve the settings suited for the day's journey. For example, your modes might be named 'DAILY RIDE', 'BOAT TRAILER', 'CARAVAN' or 'QUAD TRAILER' based on the vehicle loads or range of equipment you have to hook up to your vehicle.

## CONFIGURING AIR SUSPENSION

1. Press and hold anywhere on the **Air Suspension** module to show its settings page.



There are three options that can be set for the Front and/or Rear airbags as follows:

**None** will leave the Air Suspension inactive.

**Joined** will control them as pairs (e.g. to level the vehicle from Front to Rear).

**Split** will control each side of the vehicle independently of the other to compensate for uneven vehicle loads.

The range of control options will be dependent on the hardware and LINX accessories you have configured on your vehicle.

### SET OPERATIONAL CONTROL STATE

To set the front and/or rear airbags hardware configuration:

1. Single tap on **Joined** or **Split**.



### SET MINIMUM AND MAXIMUM AIRBAG OPERATING PRESSURES

1. Press & hold on the underlined values.





## RENAMING MODES

### RENAMING MODES

1. Scroll up, then press and hold 'Mode 4'.

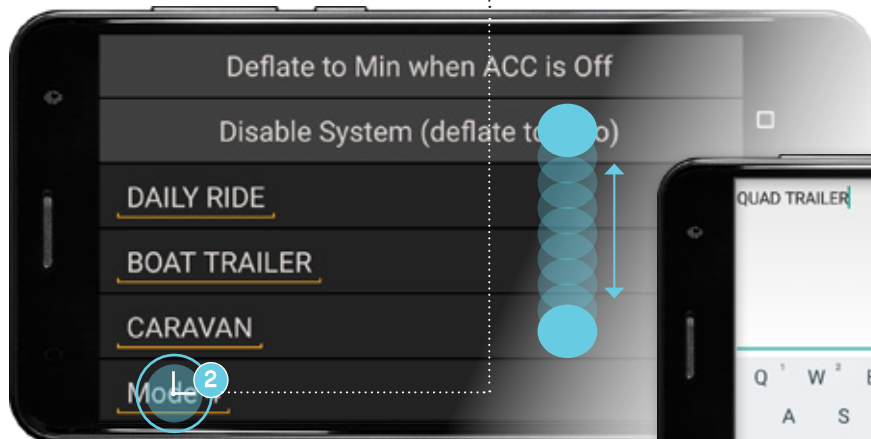

2. Change name as required, then tap **DONE**.



1. Tap the **BACK** button to return to Air Suspension module screen.

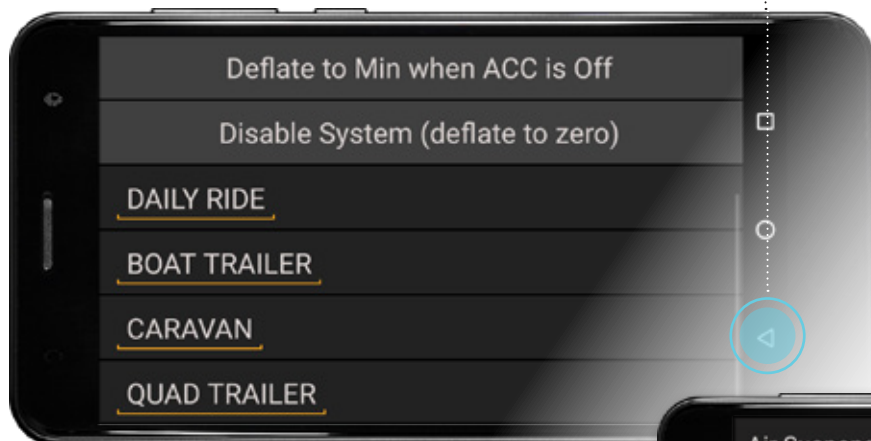

2. The screen will return to Air Suspension module screen.

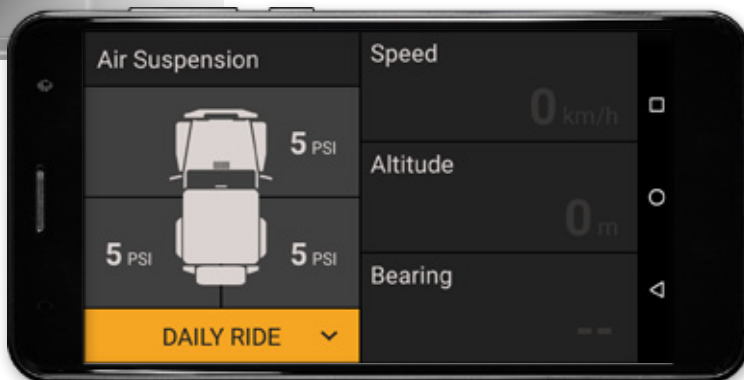

## ADJUSTING AIR PRESSURE

1. Tap the pressure value of one or more values requiring adjustment (tap near '5psi'). Tap again to deselect them.



2. Tap the + button to increment and - button to decrement the value.

Tap the value again to deselect it and it will be saved in the current mode such as "DAILY RIDE".

## CHANGING MODES

Select from the different modes by tapping on the drop down menu.

## AUTO ADJUST WITH VEHICLE START

When the vehicle is started, if it is close to level (inclinometer pitch and roll readings of less than 3 deg) and stationary, then LINX will automatically check the air suspension pressures and if required re-adjust them to the current pressure setting. For this feature to function correctly the vehicle must first be calibrated via the LINX Settings Screen by tapping the **Calibrate Vehicle** button.

## NOTES

- Parameters on the settings page that may be set by the user are shown underlined (e.g. the values next to **Min** and **Max**, and the mode names).
- Refer to your airbag manufacturer's datasheet for the recommended Min and Max operating pressures
- Disable System** option is normally used by technicians when working on and installing the system.

# INCLINOMETER MODULE

The LINX Inclinometer module monitors and displays the roll and pitch of the vehicle independent of the LINX Display. The inclinometer can be configured to sound and display and alarm to warn you of approaching your vehicle roll or pitch limit.

For the inclinometer to function correctly the vehicle must first be calibrated via the LINX Settings Screen by tapping the **Calibrate Vehicle** button.

1. Double tapping the **Inclinometer** (ROLL or PITCH) module brings up 'full screen mode' for the Inclinometer module.



## CONFIGURING THE INCLINOMETER

To enter settings for the Inclinometer modules, press and hold the module. This will show the Inclinometer settings page. To edit the Limit Alarm value, press and hold the value. Simply tap the option you wish to set. Tap again to unset it.

1. Press and hold anywhere on the **Inclinometer** module to show its settings page.



## LIMIT ALARM

A Roll / Pitch Limit Alarm when triggered will highlight in RED. For example, Roll has its Roll Limit Alarm set to 30° and the vehicles roll is at 33° which now highlights in RED. An audible alarm will also sound if selected in the settings.

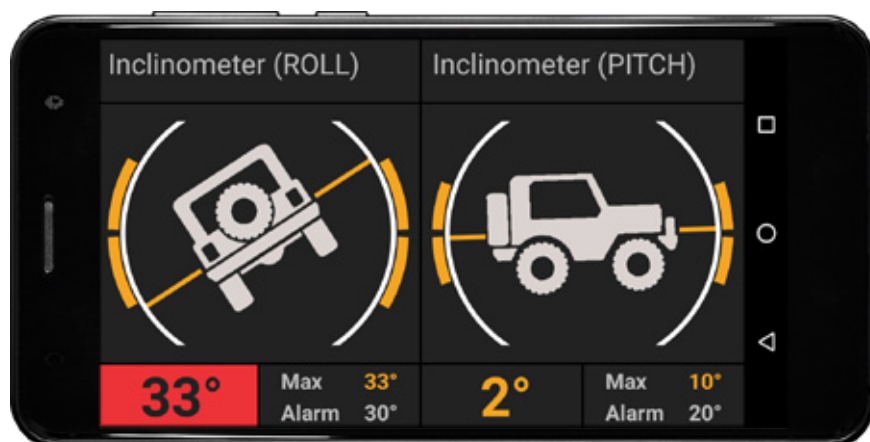

# CLOCK MODULE

The LINX Clock module includes a range of time related functions such as local and world time, date, timer, alarm, and stop watch.

The date and local time will be automatically set whenever the LINX Display is able to receive GPS signal or a SIM card is used to connect it to a telecommunications network. Alternatively the date and time can be manually set in the Android main setting menu. For help finding the Android settings menu refer to section 8.

1. To access each of the Clock functions tap on the drop down list and tap again to select.



## TIMER FUNCTION

1. Tap and hold on the underlined values to set the timer.



## ALARM FUNCTION

1. To edit the alarm time, first tap the **Enable** button.

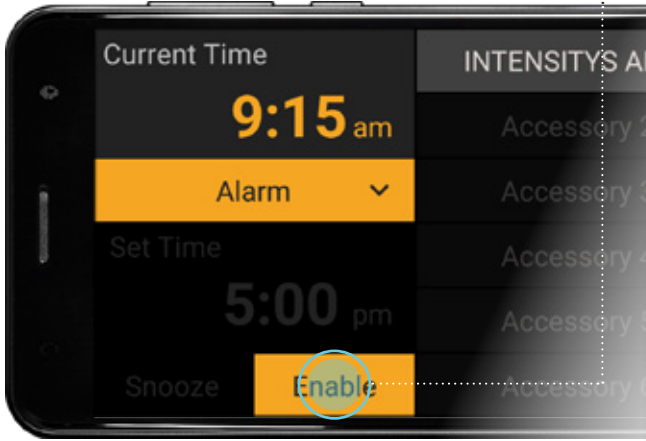

2. Tap and hold the underlined value to set the alarm time. At the alarm time an audible alarm will sound, tap **Disable** to turn the alarm off, or tap **Snooze** to add 9 minutes to the alarm time.

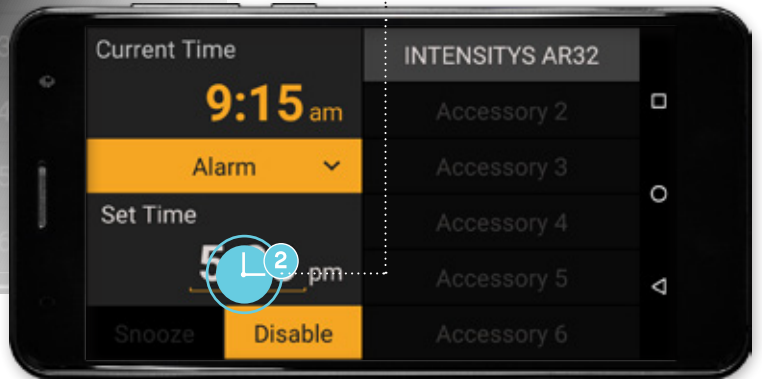

## STOP WATCH FUNCTION

1. Tap **Start** to begin.

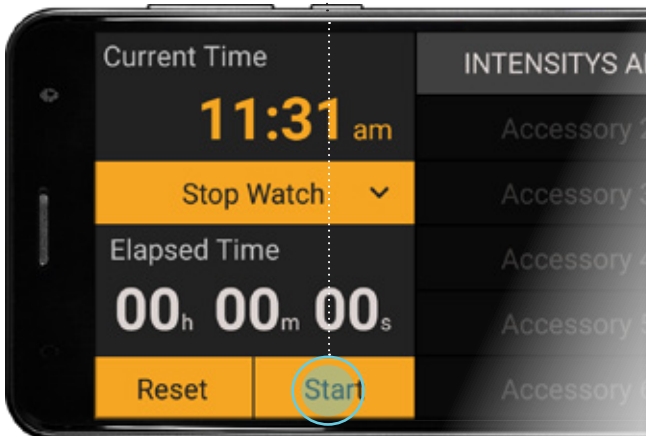

2. Tap **Stop** to end.



## WORLD TIME FUNCTION

1. Tap **Change Time Zone** to select from a list of timezones.

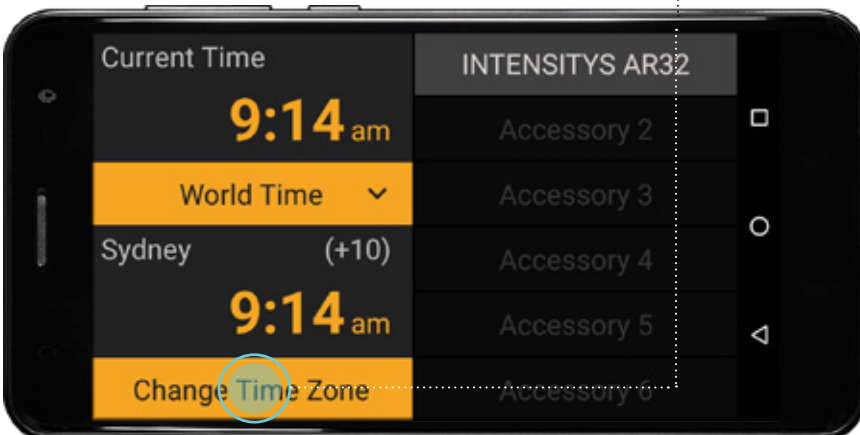

# FRIDGE MODULE

The LINX Fridge module can monitor/control the ARB Zero Fridge Freezer range and compatible ARB Classic and Elements Fridge Freezers that have been fitted with an ARB Fridge App Connect module (ARB #10900041).

When connected to an ARB Zero Fridge or Series 2 ARB Fridge the module can be used to monitor and control the Fridge. Series 1 ARB Fridge Freezer manufactured post 2014 allow monitor function only.

## CONNECTING TO THE FRIDGE

1. Tap and hold the Fridge module to enter settings.



2. Tap the **Connect to fridge** button to search for nearby fridges.

### ZERO FRIDGES

3. Tap to select 'ARB ZERO' from the list. No pin code is required to connect.

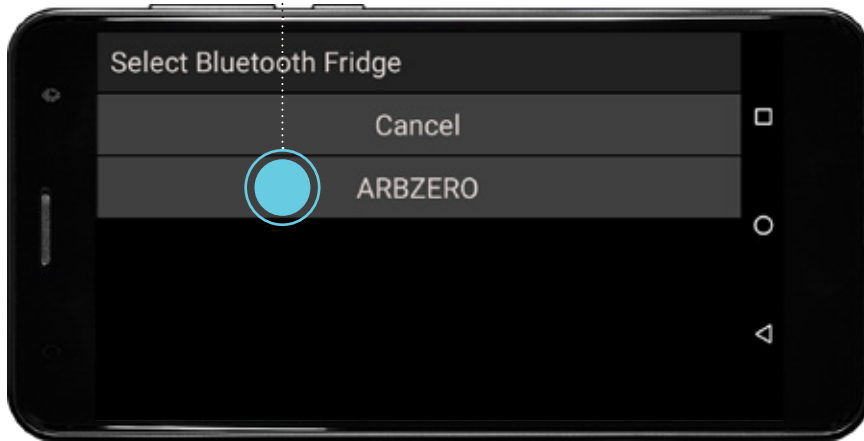

### ARB CLASSIC OR ELEMENTS FRIDGE WITH 'FRIDGE APP CONNECT MODULE'

3. Tap to select your fridge from the list. Ensure that the name matches that printed on the underside of the Fridge App Connect module.



4. You will then be asked to enter a security pin code to connect to the fridge, this is also printed on the underside of the Fridge App Connect module.

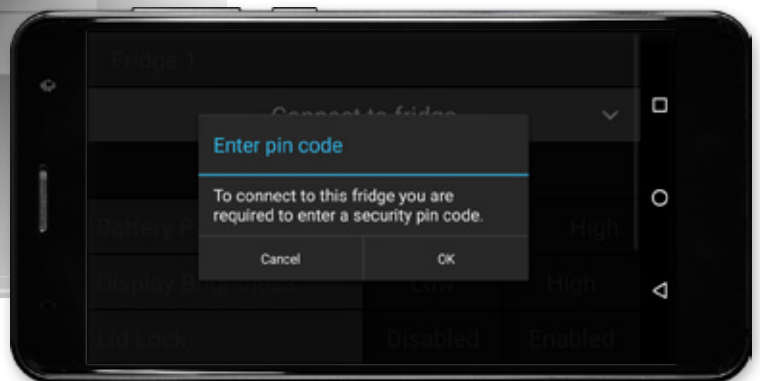



## CONFIGURING FRIDGES WITH TWO WAY COMMUNICATION

LINX auto detects which ARB fridge model it is connected to and only enables the relevant features for that model. For example:

- ARB Classic and Elements fridges, only monitor the settings and current status.
- Series 2 ARB Classic and Elements fridges with 2 way communication, monitor the status and also control the set temperature, Battery Protection level, Display Brightness, set 3 temperature mode names and values. Additionally Elements lock can be controlled.
- ARB Zero Fridge, monitor status and control the set temperature, Boost mode, Battery Protection level, set 3 temperature mode names and values.

1. To change the Battery Protection or Display Brightness on the fridge, simply tap your selection.

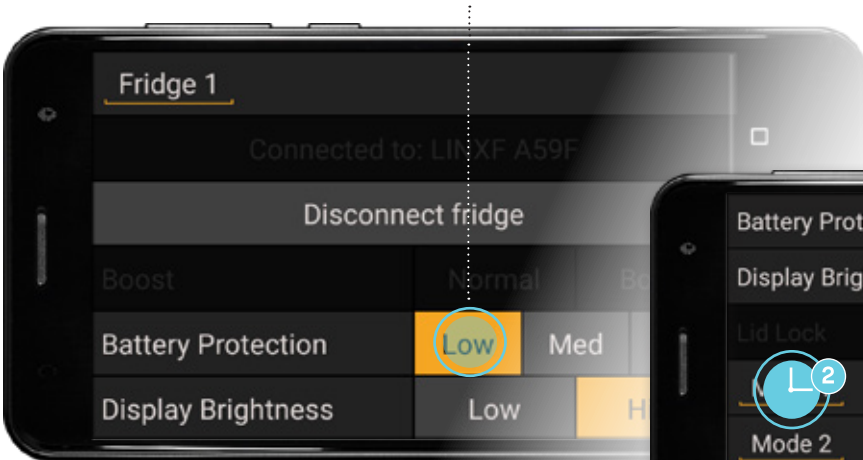

2. To change the temperature mode names and values, scroll up then press and hold the underlined text to show the keyboard. Change the name/value as required and then tap **DONE**.



3. Tap the **BACK** button to return to Fridge module screen.

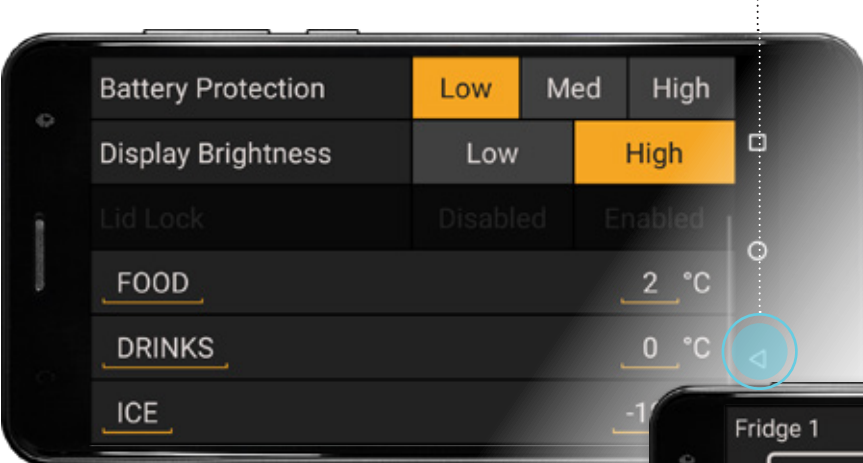

4. The screen will return to Fridge module screen.



### CHANGING MODES

1. To select different temperature modes, or turn the fridge on standby, tap the dropdown list.



2. Then tap your selection from the list to change modes.



### WARNINGS

The fridge lid open icon highlights **RED** when the lid is open.



If the fridge has a check status, such as 'Low Battery Voltage', a pop-up will be displayed with an explanation. Tap **OK** to clear the pop-up.



Tap the Check symbol to view the pop-up message again.



## FRIDGE MONITORING IN FULLSCREEN

The fridge module in fullscreen contains temperature and voltage history graphs. The graph type is selectable from the button in the top left corner.

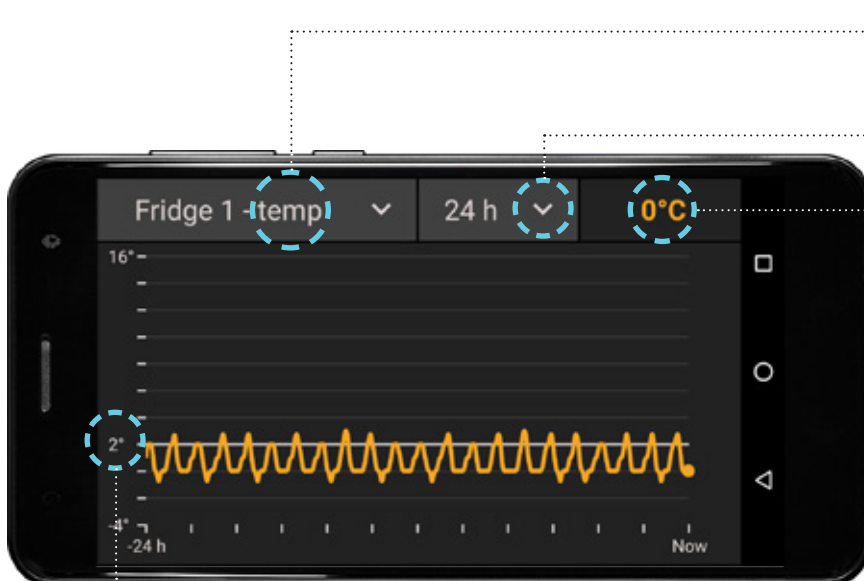

**A GRAPH TYPE SELECTION**  
Tap to select between temperature and voltage history.

**B TIME SCALE**  
Tap to select the time scale and view 6, 12 or 24 hours worth of fridge temperature and voltage history.

**C LIVE READING**  
Displays the fridges current temperature or voltage.

**D TEMPERATURE SET POINT**  
The set temperature is shown in the as the solid horizontal white line.

Single tap anywhere on the history graph (left side of the screen) to show the fridge temperature (or voltage) data for that point in time.

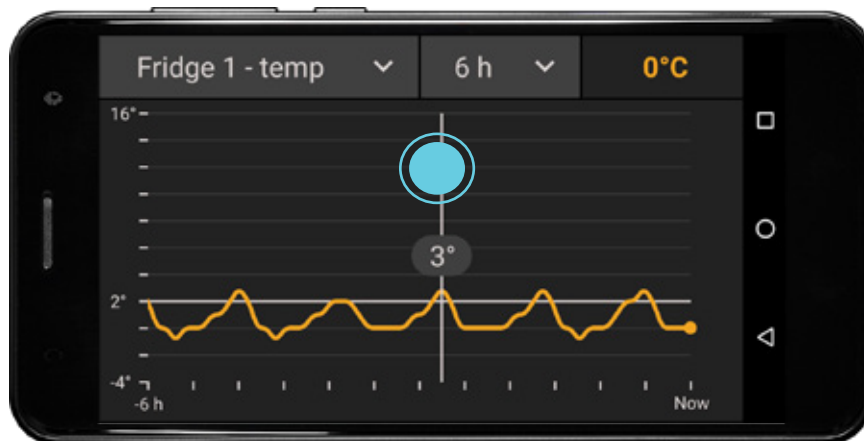

# TPMS MODULE

The LINX TPMS module monitors ARB Air Systems TPMS sensors through the use of the LINX TPMS Comms Box (ARB #7450116). It displays the current tyre pressure and temperature. It sounds and displays alerts related to pressure, temperature, sensor low battery and a non-communicating sensor.

Once trailers have been configured LINX it will automatically switch between them, or active/deactivate them when are are connected/disconnected to your vehicle.

The **TPMS (Vehicle)** module supports 4 tyre sensors and 2 spare tyre sensors. 4 modes can be programmed each with different names and set pressures for front and rear tyres, accomodating the wide range of 4x4 tyre pressures that may be used in different terrain and load conditions.

The **TPMS (Trailer)** module supports up to 3 different trailers each with 4 tyre sensors and 2 spare tyre sensors. Each trailer also has 4 modes that can be programmed with a single set pressure for all tyres. Additionally each trailer can be named, configured as single or tandem axle and an appropriate icon chosen.

A pressure alert will occur if a tyre pressure is above or below it set pressure +/- the pressure variation alert.

The setting for temperature alert applies to all tyres, and the spare tyre set pressure applies to all spare tyres on the vehicle and trailers.

## CONNECTING TO THE LINX TPMS COMMS BOX

1. Tap and hold the **TPMS** module to enter settings.

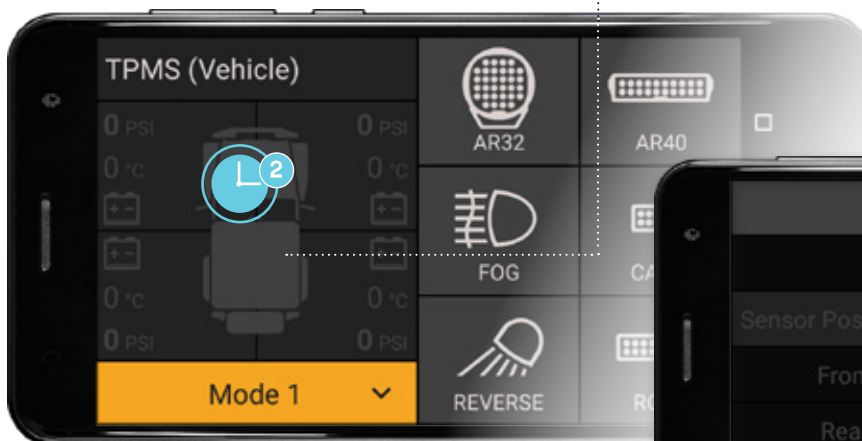

2. Tap the **Connect to TPMS** button to search for your TPMS Comms Box.

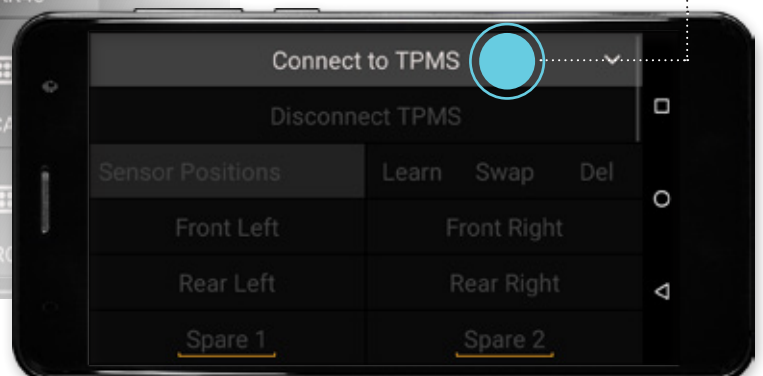

3. Tap to select your LINX TPMS Comms Box 'LINXTPMS 1234' from the list.



## SENSOR POSITION PROGRAMMING

1 vehicle and 3 trailers can be programmed with up to 4 tyre sensors and 2 spare tyre sensors. To Learn the sensors and their positions follow the on screen text pop ups. The sensor positions can be quickly and easily swapped if you rotate your tyres or change to a spare tyre.

### SENSOR POSITION LEARNING

1. Tap the **Learn** button. At first all tyre positions are shown in light grey, indicating no tyre sensor has been associated with this position.



When a sensor position has been associated with a tyre sensor the button is shown in the LINX theme colour. Shown here all 4 vehicle tyre sensor positions have been learned.



### SENSOR POSITION SWAPPING

1. Tap the **Swap** button. Then tap the two sensor positions you would like to swap.

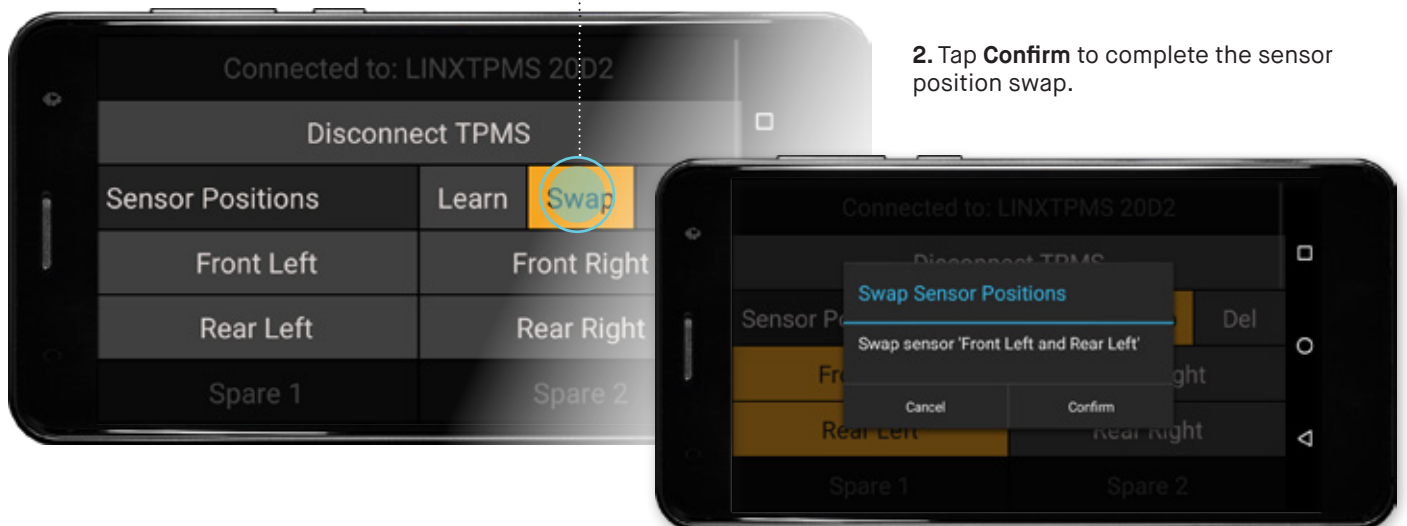

## SENSOR POSITION DELETE

1. Tap the **Delete** button. Then tap the sensor positions you would like to delete.



2. Tap **Confirm** to complete the sensor position delete.

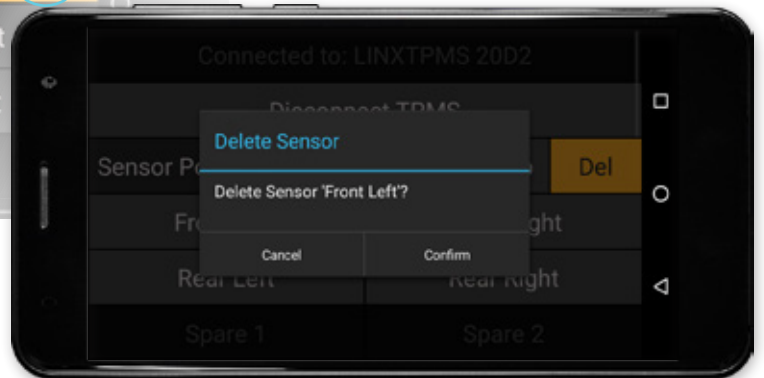

## CONFIGURING TPMS ALERTS

### TPMS (VEHICLE) SETTINGS

The vehicle has 4 modes available, each of which can named and configured with different set pressures for the front tyres and the rear tyres, accomodating the wide range of 4x4 tyre pressures that may be used in different terrain and load conditions.

To change the alert values, pressure mode names and values, scroll up then press and hold the underlined text to show the keyboard. Change the name/value as required and then tap **DONE**.

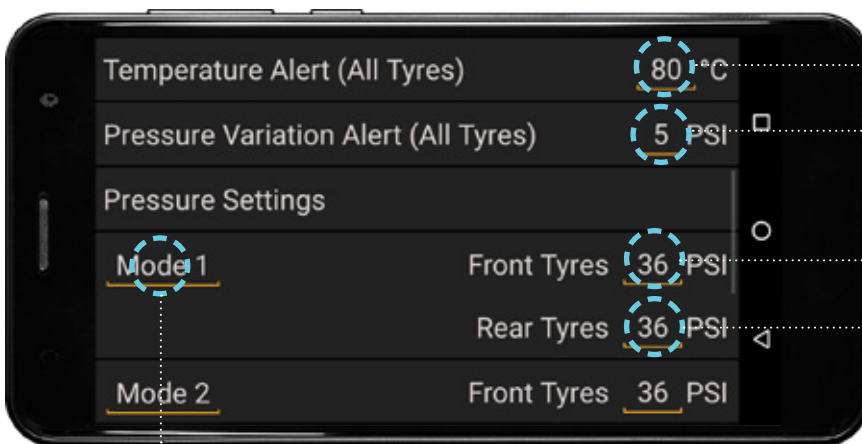

- A TEMPERATURE ALERT**  
Alert will occur when any tyre temperature is above this setting.
- B PRESSURE VARIATION ALERT**  
Alert will occur if a tyre pressure is above or below it set pressure +/- the pressure variation alert.
- C FRONT TYRES (MODE 1)**  
This pressure setting applies to the front tyres when in Mode 1.
- D REAR TYRES (MODE 1)**  
This pressure setting applies to the rear tyres when in Mode 1.
- E MODE NAME**  
Customizable mode names.

**Note:** The alert pressure is calculated using the **Pressure Setting** for the current mode and the **Pressure Variation Alert**. Eg. In the example above the Mode 1 Front Tyres are set to 36 PSI, an alert would occur if the tyre pressure is below 31 PSI (= 36 - 5), or is the tyre pressure is above 41 PSI (= 36 + 5).

### TPMS (TRAILER) SETTINGS

The trailer settings are similar to the vehicle with the addition that each trailer can be named, configured as single or tandem axle and an appropriate icon chosen.

**A TRAILER MENU**  
Tap to select which trailer to monitor.

**B TRAILER NAME**  
Each trailer can be individually named.

**C SINGLE/TANDEM AXLE**  
Tap to select whether the trailer is single or tandem axle.

**D TRAILER DISPLAY**  
Tap to select an appropriate icon for the trailer display.

### TPMS DISPLAY

The LINX TPMS Comms Box is powered on with the vehicle accessories or ignition, and so it is not active when the vehicle is turned off, as shown below with the vehicle and readouts in grey.

When the vehicle accessories are turned on and the TPMS is active the vehicle is shown in white, and when data is recieved from the tyre sensors they are shown in LINX theme colour.



### TYRE PRESSURE ALERT

When tyre pressures are outside the allowable set pressure variation, LINX will sound an audible alert and highlight the tyre sensor corner with the issue in **RED** as shown.



### TYRE SENSOR NOT COMMUNICATING ALERT

The LINX TPMS modules will display the 'sensor not communicating' alert if no data has been received from a sensor for more than 10 minutes and the vehicle speed is greater than 20km/h [12mph]. This speed feature avoids receiving unnecessary alerts when driving offroad at low speeds, as the tyre sensors don't wake-up until the vehicle speed is at least 15km/h [10mph].

Before any data is received from a tyre sensor the readouts will just remain grey.



The 'sensor not communicating' alert will be displayed if no data has been received from a sensor for more than 10 minutes and the vehicle speed is greater than 20km/h [12mph].

## AUTOMATIC TRAILER DETECTION

### TRAILER CONNECTION

When you physically connect a trailer to your vehicle, LINX will receive data from that trailer's sensors once you start moving. If the trailer is not currently activated in the TPMS (Trailer) module, LINX will ask if you want to activate that trailer.

**Note:** All your trailers must first be configured in LINX and the Sensor position programming completed as described earlier in this section.

A pop-up will inform you when a connected trailer has been detected. Select 'Yes' to simply activate it and start monitoring it for pressure and temperature alerts. Select 'Yes and Show' to also show it in split screen view. Or select Ignore if you don't want to activate it.

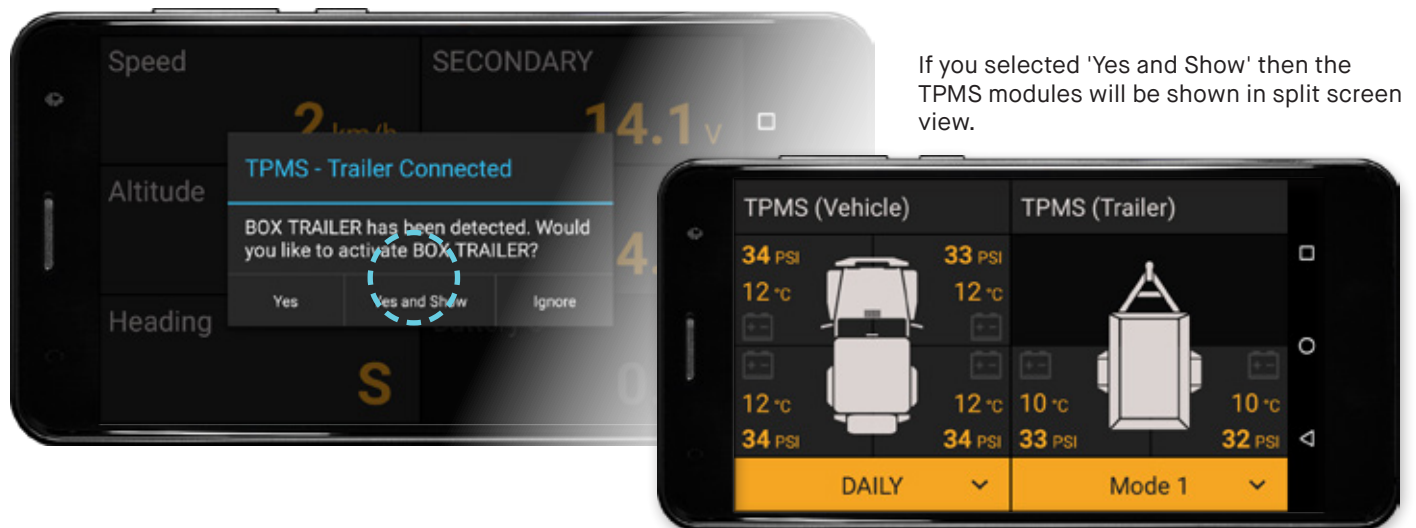

### TRAILER DISCONNECTION

If no data is being received from any of the tyre sensors of your currently activated trailer, then LINX will ask if the trailer has been disconnected and hide it until it is connected again, rather than continuously displaying 'sensor not communication' alerts.

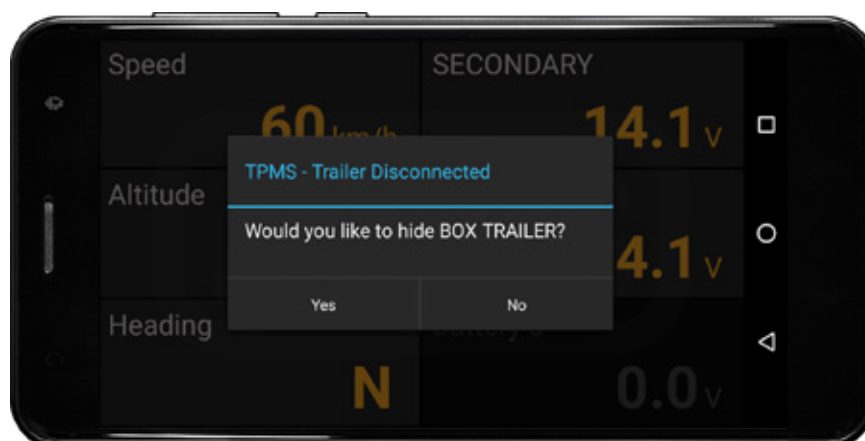



# COMPLIANCE INFORMATION

[BACK TO TABLE OF CONTENTS](#)

# COMPLIANCE INFORMATION

## EUROPE - EU DECLARATION OF CONFORMITY

---

This declaration of conformity is issued under the sole responsibility of the manufacturer.

This declaration relates to these products:  
LINX 1.0

The products are in conformity with the following standards or standardized documents:

ETSI EN 301 489-17 V3.1.1:2017  
ETSI EN 301 489-1 V2.1.1:2017  
ETSI EN 300 328 V2.1.1:2016  
EN 60950-1:2006 + A11:2009 + A1:2010 + A12:2011 + A2:2013  
IEC 60950-1:2005 (Second Edition) + Am 1:2009 + Am 2:2013

According to the provisions of the directives:

2014/53/EU (Radio Equipment Directive)  
2014/30/EU (Electromagnetic Compatibility Directive)  
2014/35/EU (Low Voltage Directive)

Technical file at:  
ARB Corporation Ltd, 42-44 Garden St, Kilsyth, Victoria, Australia

Signed for and on behalf of ARB Corporation Ltd



Andrew Brown  
Managing Director  
Melbourne, March 2018

## USA - FCC STATEMENT

---

This device complies with part 15 of the FCC Rules. Operation is subject to the following two conditions: (1) this device may not cause harmful interference, and (2) this device must accept any interference received, including interference that may cause undesired operation.

This equipment has been tested and found to comply with the limits for a Class B digital device, pursuant to part 15 of the FCC Rules. These limits are designed to provide reasonable protection against harmful interference in a residential installation. This equipment generates, uses and can radiate radio frequency energy and, if not installed and used in accordance with the instructions, may cause harmful interference to radio communications. However, there is no guarantee that interference will not occur in a particular installation. If this equipment does cause harmful interference to radio or television reception, which can be determined by turning the equipment off and on, the user is encouraged to try to correct the interference by one or more of the following measures:

- Reorient or relocate the receiving antenna.
- Increase the separation between the equipment and receiver.
- Connect the equipment into an outlet on a circuit different from that to which the receiver is connected.
- Consult the dealer or an experienced radio/TV technician for help.

### FCC CAUTIONS

Changes or modifications made to this device that are not expressly approved by ARB Corporation Ltd may void the user's authority to operate the equipment. This device must not be co-located or operated in conjunction with any other antenna or transmitter.

### FCC RADIATION EXPOSURE STATEMENT

This equipment complies with FCC radiation exposure limits set forth for an uncontrolled environment. This equipment should be installed and operated with minimum distance of 20 cm between the radiator and your body.

## ENVIRONMENTAL PROTECTION

---

Waste electrical products should not be disposed of with household waste. Please recycle where facilities exist. Check with your local authority or retailer for recycling advice.

## INTERNATIONAL OFFICES

### HEAD OFFICE

ARB 4X4 ACCESSORIES  
42-44 Garden Street,  
Kilsyth Victoria 3137 Australia  
Tel: +61 (03) 9761 6622  
Fax: +61 (03) 9761 6807  
Email: exports@arb.com.au  
Web: www.arb.com.au

### NORTH AMERICA

720 SW 34th Street  
Renton, WA 98057  
Tel: +1 (425) 264 1391  
Fax: +1 (425) 264 1392  
Email: sales@arbusa.com  
Web: www.arbusa.com

### CENTRAL & SOUTH AMERICA

3700 Port Jacksonville Pkwy Suite  
#1, Jacksonville FL 32226, USA  
Tel: +1 (904) 379 8216  
Fax: +1 (904) 813 7197  
Email: latam@arbusa.com

### EUROPE

Na Dlouhém čc.80, DC2,  
Říčany - Jazlovic,  
251 01, Czech Republic  
Tel: +420 323 040 900  
Fax: +420 323 040 910  
Email: purchasingeu@arb.com.au  
Web: www.arbeurope.com

### THAILAND

Building GW1, 300/56,  
Moo 1, Tambon Tasit,  
Amphur Pluakdaeng,  
Rayong, 21140, Thailand  
Tel: +66 (0) 38 929 672  
Fax: +66 (0) 38 929 676  
Email: sales.thailand@arb.com.au  
Web: www.arb.co.th

### MIDDLE EAST

ARB Middle East FZE  
LIU15, RA07AB05  
Jebel Ali Freezone,  
North Dubai, United Arab Emirates  
Tel: +971 4 880 7005  
Email: purchasingmena@arb.com.au

### OTHER REGIONS

Please contact our  
Export Department  
Tel: +61 3 9761 6622  
Email: exports@arb.com.au

## ARB STORES

### VICTORIA

Bairnsdale (03) 5152 1226  
Ballarat (03) 5336 4605  
Bendigo (03) 5445 7100  
Brighton (03) 9557 1888  
Dandenong (03) 9793 0002  
Echuca (03) 5480 2600  
Geelong (03) 5272 2611  
Hoppers Crossing (03) 9749 5905  
Keilor Park (03) 9331 7333  
Kilsyth (03) 9761 6622  
Pakenham (03) 5940 5500  
Shepparton (03) 5822 1877  
Somerton (03) 9460 9988  
Traralgon (03) 5174 9190

### SOUTH AUSTRALIA

Elizabeth (08) 8252 1599  
Morphett Vale (08) 8186 6101  
Regency Park (08) 8244 5001

### ACT

Fyshwick (02) 6280 7475

### NEW SOUTH WALES

Albury (02) 6021 2477  
Artarmon (02) 9438 4484  
Broken Hill (08) 8087 9250  
Brookvale (02) 8507 3073  
Dubbo (02) 6885 5777  
Moorebank (02) 9821 3633  
Newcastle (02) 4953 9555  
Orange (02) 6369 0700  
Penrith (02) 4731 1266  
Port Macquarie (02) 6581 2500  
St Peters (02) 9565 2455  
Tamworth (02) 6762 0541  
Thornleigh (02) 9980 8855  
Wagga Wagga (02) 6925 8777  
Wentworthville (02) 9631 7889

### WESTERN AUSTRALIA

Canning Vale (02) 9455 4366  
Geraldton (08) 9921 8077  
Mandurah (08) 9583 3200  
Osborne Park (08) 9244 3553  
Wangara (08) 9409 5764  
Welshpool (08) 9358 3688

### NORTHERN TERRITORY

Alice Springs (08) 8953 0572  
Darwin (08) 8947 2262

### QUEENSLAND

Biggera Waters (07) 5537 8800  
Bundaberg (07) 4153 2929  
Burleigh Heads (07) 5535 9223  
Caboolture (07) 5499 1955  
Capalaba (07) 3823 5900  
Cairns (07) 4035 3350

Caloundra (07) 5491 4500  
Coopers Plains (07) 3277 2020  
Jindalee (07) 3715 6400  
Nundah (07) 3266 3255  
North Lakes (07) 3491 9600  
Springwood (07) 3493 3030  
Mackay (07) 4998 6888  
Maroochydore (07) 5475 4011  
Rockhampton (07) 4922 7788  
Toowoomba (07) 4632 1122  
Townsville (07) 4728 0900

### TASMANIA

Burnie (03) 6431 4494  
Hobart (03) 6232 2333  
Launceston (03) 6331 4190

